



CITY OF NEWBURYPORT
CONSERVATION COMMISSION
60 PLEASANT STREET
NEWBURYPORT, MA 01950
978-465-4462

REQUEST FOR MINOR MODIFICATION TO ORDER OF CONDITIONS

Filing Fee: \$25.00

Please fill out completely the following form, attach revised plans, and include a check for \$25.00, made payable to the City of Newburyport. Submit check and two paper copies to the Conservation Commission at City Hall and email the entire Request, including attachments, in .pdf format to: jgodtfredsen@cityofnewburyport.com.

Date:	
Name and Address of Applicant:	
Project Location:	DEP File Number:
Order of Conditions Issue Date:	Map/Plat No.:
Original Approved Project Plans (title and date):	
Requested Changes to Approved Plans (Please outline in detail all requested changes, resource areas affected, any associated calculations of impacts, and reason for changes. If necessary, refer to an attachment):	

Additional Mitigation Proposed (if any):
Revised Project Plans (title and date) Please attach all:
Signature of Applicant:

APPROVAL OF MINOR MODIFICATIONS

Conservation Commission Signatures:

Signed Date: _____



Known for excellence.
Built on trust.

GEOTECHNICAL

ENVIRONMENTAL

ECOLOGICAL

WATER

CONSTRUCTION
MANAGEMENT

144 Elm Street
Amesbury, MA 01913
T: 781.278.4800
F: 978.834.6269
www.gza.com



SENT VIA ELECTRONIC MAIL April 12, 2021
April 12, 2021
GZA File No. 18.0171603.03

Newburyport Conservation Commission
Newburyport City Hall
60 Pleasant Street
Newburyport, MA 01950

Re: Request for Minor Modification to Order of Conditions File No. 051-0920
Shoreline Resiliency: Critical Infrastructure Protection and Clipper City Rail Trail Project
Newburyport, Massachusetts

Dear Commission Members:

On behalf of the City of Newburyport, GZA GeoEnvironmental, Inc. (GZA) is submitting this letter to request a Minor Modification to the Amended Order of Conditions for the above-referenced Project issued on April 14, 2020. We are seeking to request a change to include new hot mix asphalt (HMA) paving along the access driveway to the American Yacht Club at 115 Water Street, Newburyport, MA. Refer to the attached Proposed Access Driveway Paving Plan. The following provides information on the Project background, proposed work, resource area assessment, stormwater management, and mitigation measures.

BACKGROUND

The City hired contractor is currently constructing the final section of the Phase 2 Clipper City Rail Trail located between Water Street and the American Yacht Club. The work includes reconstruction of the stone sloped revetment and a raised berm with a paved recreational trail on top in accordance with the Amended Order of Conditions issued on April 14, 2020 for File No. 051-0920. The proposed construction is scheduled to be completed by June 2021.

PROPOSED WORK

The City proposes to construct approximately 1610 square feet of new HMA pavement at the access driveway to the American Yacht Club connecting the existing HMA paved parking/driveway area to the HMA paved multi-use recreational pathway. The proposed HMA pavement will be 15 feet in width and will generally be pitched to the North towards the existing gravel area/grassed buffer low spot adjacent to the existing recreational pathway. The proposed paved driveway is desirable for the following reasons:

- Provides a smoother and safer surface from the existing paved parking/ driveway area to the paved recreational pathway.
- Reduces extent of gravel and mud tracked directly on to the multi-use recreational pathway, potentially impacting users.



- Provides a stable surface less susceptible to erosion and/or tire ruts.
- Easier to maintain during snow removal processes (e.g. plowing).

An approximate 7-foot-wide gravel strip between the existing concrete curb and west edge of proposed HMA pavement is proposed to remain as-is to match existing conditions and provide stormwater infiltration. A variable width area totaling 530 square feet between the existing grassed area and the east edge of proposed HMA pavement is proposed to receive loam and seed to re-establish the vegetated grassed strip adjacent to the existing concrete walkway. The northernmost tree is proposed to be removed and replaced with a similar 3 to 4-inch caliper sycamore tree. The tree is to be replaced due to potential compaction and root suffocation from truck deliveries as part of the on-going construction work for the Clipper City Rail Trail Project.

RESOURCE AREAS

The proposed work is located within Land Subject to Coastal Storm Flowage (LSCSF) and Riverfront Area associated with the Merrimack River resulting in 1610 square feet of permanent impacts to these Resource Areas for proposed new HMA pavement. The proposed work will not adversely affect the function of the resource areas. Erosion control measures will be installed prior to the start of work and will remain in place and in good repair throughout the construction process. Temporarily disturbed areas will be restored to pre-existing conditions.

STORMWATER MANAGEMENT

The Project will meet the Massachusetts Department of Environmental Protection Stormwater Management Standards to the maximum extent practicable. The proposed HMA pavement will generally be pitched to the North towards the existing gravel area/grassed buffer low spot adjacent to the existing recreational pathway, to generally match the existing stormwater runoff conditions. This natural drainage area is a low spot and currently collects stormwater runoff from the immediately adjacent area. The west side of the proposed HMA pavement is proposed to remain a gravel strip to act as a gravel diaphragm to provide stormwater infiltration and pretreatment, and will be also be utilized for snow removal stockpiling. The east side of the proposed HMA is proposed to receive new loam and seed to reestablish the existing vegetated buffer with grasses and existing trees between the vehicle driveway and existing concrete walkway.

The proposed work will be performed in accordance with the Stormwater Report prepared for the Clipper City Rail Trail – Phase 2 prepared by Stantec Consulting Services, Inc. as well as the Stormwater Pollution Prevention Plan prepared for the Shoreline Resiliency: Critical Infrastructure Protection and Clipper City Rail Trail Project prepared by Eckman Engineering, LLC dated December 4, 2020.

MITIGATION MEASURES

Mitigation measures of the proposed work includes the following:

- Reestablish the existing vegetated buffer on the east side of the proposed HMA with new loam and seed, totaling approximately 530 square feet of new vegetated area.
- Remove and replace the northernmost 3 to 4-inch caliper sycamore tree due to potential compaction and root suffocation from truck deliveries.



- Maintain a gravel strip on the west side of the proposed HMA to provide stormwater infiltration and pretreatment and provide an area for snow removal stockpiling.
- Direct stormwater runoff towards the existing gravel area/grassed buffer low spot to generally match the existing stormwater runoff conditions.

We look forward to meeting with the Commission to discuss the proposed amendment change. Should you have any questions or comments regarding this submittal, please contact our office at (781) 278-4806.

Sincerely,
GZA GEOENVIRONMENTAL, INC.

A handwritten signature in black ink, appearing to read 'David A. Smith', is positioned above the printed name.

David A. Smith
Senior Project Manager

Attachments: Proposed Access Driveway Paving Plan
Photographic Log

Cc: Geordie Vining, Senior Project Manager, City of Newburyport
Christopher Pratt, Chief Operator, City of Newburyport

**NEWBURYPORT
SHORELINE RESILIENCY: CRITICAL INFRASTRUCTURE
PROTECTION AND CLIPPER CITY RAIL TRAIL PROJECT**

STATE	MUNICIPALITY	SHEET NO.	TOTAL SHEETS
MA	NEWBURYPORT	1	1

APRIL 12, 2021

12-Apr-2021
CCRT_DRIVEWAY_PLANS_GZA.DWG

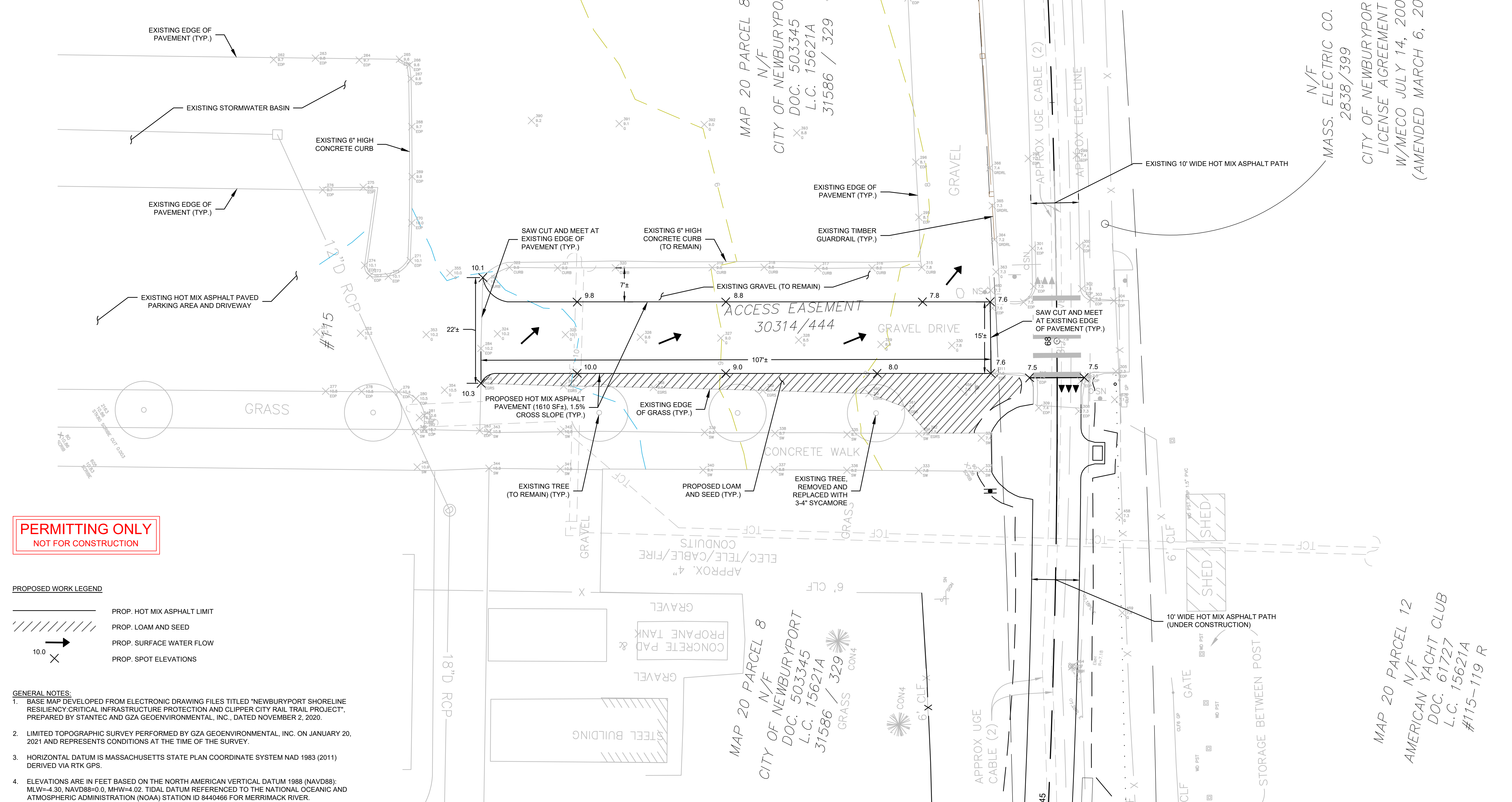
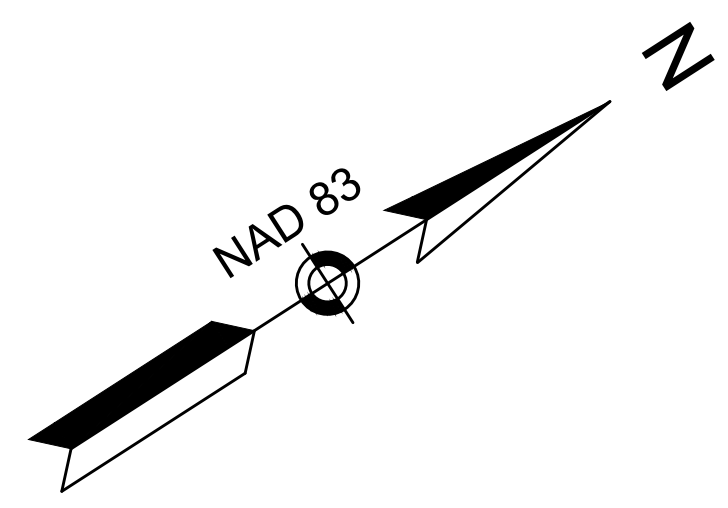

PERMITTING ONLY
NOT FOR CONSTRUCTION

PROPOSED WORK LEGEND

- PROP. HOT MIX ASPHALT LIMIT
- PROP. LOAM AND SEED
- PROP. SURFACE WATER FLOW
- PROP. SPOT ELEVATIONS

GENERAL NOTES:

1. BASE MAP DEVELOPED FROM ELECTRONIC DRAWING FILES TITLED "NEWBURYPORT SHORELINE RESILIENCY-CRITICAL INFRASTRUCTURE PROTECTION AND CLIPPER CITY RAIL TRAIL PROJECT", PREPARED BY STANTEC AND GZA GEOENVIRONMENTAL, INC., DATED NOVEMBER 2, 2020.
2. LIMITED TOPOGRAPHIC SURVEY PERFORMED BY GZA GEOENVIRONMENTAL, INC. ON JANUARY 20, 2021 AND REPRESENTS CONDITIONS AT THE TIME OF THE SURVEY.
3. HORIZONTAL DATUM IS MASSACHUSETTS STATE PLAN COORDINATE SYSTEM NAD 1983 (2011) DERIVED VIA RTK GPS.
4. ELEVATIONS ARE IN FEET BASED ON THE NORTH AMERICAN VERTICAL DATUM 1988 (NAVD88): MLW=-4.30, NAVD88=0.0, MHW=4.02. TIDAL DATUM REFERENCED TO THE NATIONAL OCEANIC AND ATMOSPHERIC ADMINISTRATION (NOAA) STATION ID 8440466 FOR MERRIMACK RIVER.
5. LOCATION OR PRESENCE OF UTILITIES SHOWN ARE APPROXIMATE. CONTRACTOR MUST NOTIFY DIGSAFE 72 HOURS PRIOR TO COMMENCING WORK. VERIFY LOCATIONS, DEPTHS AND OVERHEAD CLEARANCE OF ALL EXISTING UTILITIES AND NOTIFY THE APPROPRIATE UTILITY COMPANY AND AUTHORITY TO ALLOW MARKING OF THEIR LINES.
6. ENTIRE SITE IS WITHIN LAND SUBJECT TO COASTAL STORM FLOWAGE (100 YEAR FLOOD ZONE) AND RIVERFRONT AREA (200' OFFSET FROM MHW).

PROPOSED ACCESS DRIVEWAY PAVING PLAN
SCALE: 1"=10'

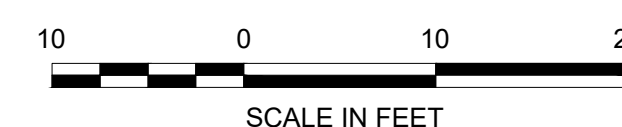

N/F
MASS. ELECTRIC CO.
2838/399

CITY OF NEWBURYPORT
LICENSE AGREEMENT
W/MECO JULY 14, 2003
(AMENDED MARCH 6, 2008)

MAP 20 PARCEL 8
N/F
CITY OF NEWBURYPORT
DOC. 503345
L.C. 15621A
31586 / 329

MAP 20 PARCEL 12
N/F
AMERICAN YACHT CLUB
DOC. 61727
L.C. 15621A
#115-119 R

PREPARED FOR

CITY OF NEWBURYPORT
60 PLEASANT STREET
NEWBURYPORT, MA 01950

PREPARED BY

GZA GEOENVIRONMENTAL, INC.
144 ELM STREET
AMESBURY, MA 01913



Photographic Log

Client Name: City of Newburyport		Site Location: 115 Water Street, Newburyport, MA	GZA File No. 18.0171603.03
Photo No. 1	Date: 10/14/20		
Direction Photo Taken: Northeast			
Description: Existing edge of pavement and existing gravel driveway (approximate location of proposed new asphalt pavement). Left: Existing concrete curb and existing paved driveway. Right: Existing grass and trees and concrete walkway.			

Photo No. 2	Date: 10/14/20		
Direction Photo Taken: Southwest			
Description: Existing edge of pavement at driveway of AYC property (proposed new pavement tie-in).			



Photographic Log

Client Name: City of Newburyport		Site Location: 115 Water Street, Newburyport, MA	GZA File No. 18.0171603.03
Photo No. 3	Date: 10/14/20		
Direction Photo Taken: North			
Description: View of existing paved walkway and paved driveway at AYC property.			

Photo No. 4	Date: 10/14/20		
Direction Photo Taken: Northwest			
Description: View of gravel and grassed area between existing paved walkway and paved parking lot. Also note keypad for AYC gate and bollards and boulder (all to remain).			