

City Hall Renovation Feasibility Study



City Hall Renovation Feasibility Study

- Built: 1851
- Architect: Frederick J Coffin
- Style: Italianate
- From National Register: “The building’s plan resembles that of earlier public buildings; however, its large scale and exterior facings of pressed brick laid up in stretcher bond trimmed with dressed brownstone mark the introduction of these details into local architecture. Characteristic of its style, the building possesses a deep boxed cornice with brackets, and an ornate bracketed hood over the entry.”

City Hall Renovation Feasibility Study

- 28,500 square feet
- Under a preservation restriction, so modifications will be minor and in keeping with the PR agreement
- In need of several interior upgrades and modifications
 - No effective wayfinding for the public, not welcoming
 - Office spaces are not organized effectively, scattered
 - Many offices have no access to natural light
 - Storage should be archived and/or purged
 - Retain and celebrate the building's history
 - System upgrades including AV, IT and HVAC

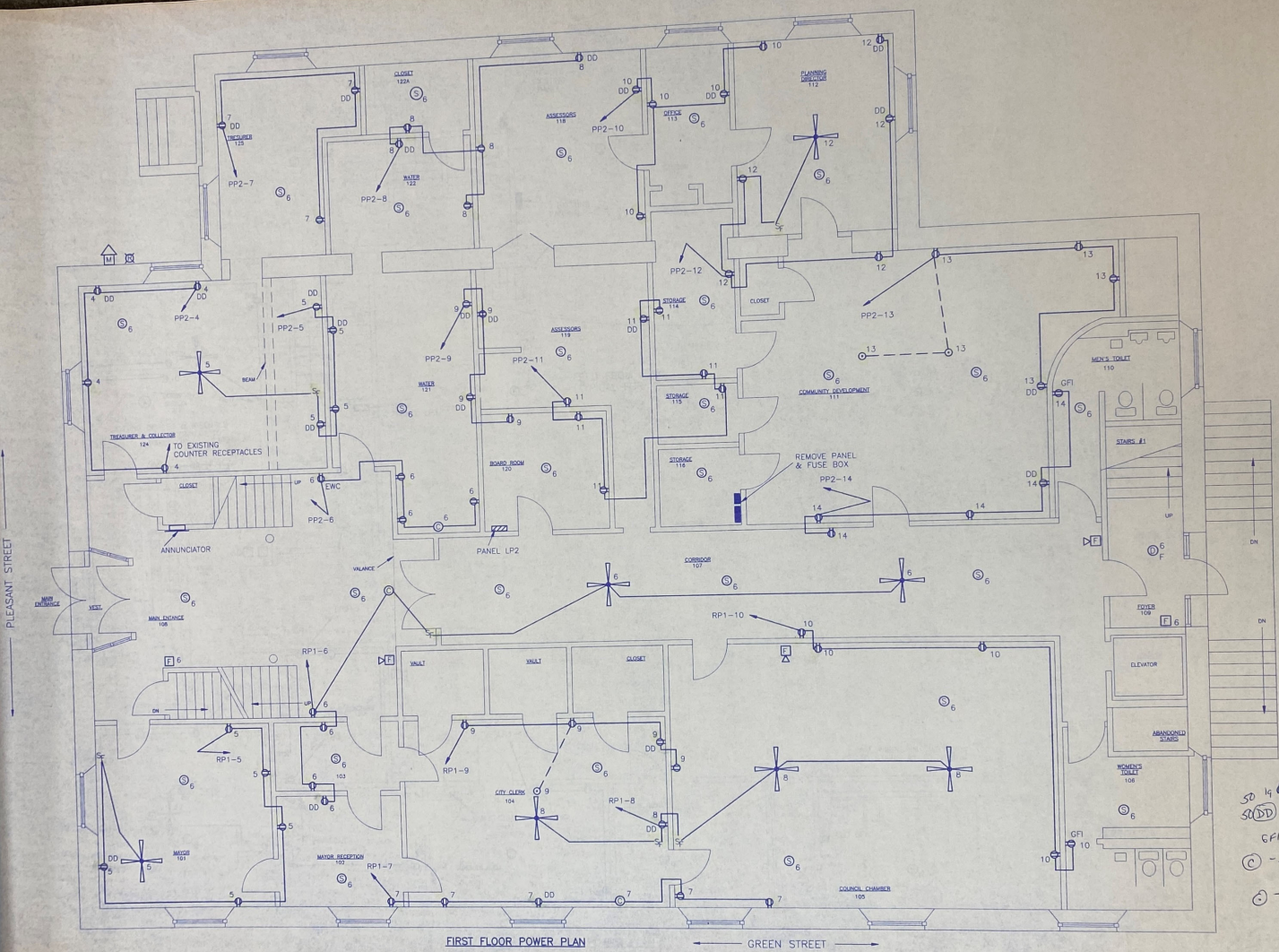

FIRST FLOOR POWER PLAN

Woodman Associates

Architecture
 Research
 Design
 Planning
 Land Use Planning

20 Inn Street
 Newburyport, MA
 01950 USA

508-462-9522
 Project
 City Hall

Location
 Pleasant Street
 Newburyport, MA

Drawing Title
**FIRST FLOOR
 POWER PLAN**

Scale
 NONE
 Date
 12-21-93
 Consultants

McCABE ASSOCIATES
 45 Stiles Rd.
 Salem, NH
 03079 USA
 603-893-5224



SEE BOOK SPECIFICATIONS
 FOR ADDITIONAL INFORMATION
 AND PROJECT REQUIREMENTS

Drawn by
 D.J.H.
 Checked by
 R.M.
 Revisions

SD 4
 SDD → 25 plates
 GF1 - 2
 - 3
 - 2

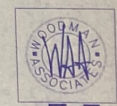

E-7
 Drawing No.

City Hall Renovation Feasibility Study

- \$47,000 in CPC funding has been requested by the Mayor's Office to hire a consultant to conduct a preliminary analysis, schematic design and phasing strategy, and cost estimates
- Requesting support from the Historical Commission for this effort