

**KEY**

**1 - REPLACE DECK WITH A NEW 12'X16' DECK (ONE-TWO STEPS AROUND PERIMETER OF ENTIRE SURFACE - LOW AND NON INTRUSIVE WITHOUT RAILING)**

**2 - REPLACE FRONT STEPS - WITH NEW CINDERBLOCK AND CRUSHED STONE STAIRS  
NOTE: THERE WILL BE NO CEMENT USED AS PART OF THE BASE BUILDING AS SHOWN)  
TOPPED WITH GRANITE TREADS**



**BEFORE**

**AFTER**



**3 - ADD TO BASE OF CRUSHED STONE SAND OR CRUSHED SHELLS, WE ARE FAVORABLE TO WHICHEVER OPTION SUPPORTS THE BEST GROWTH OF MORE BEACH AND DUNE GRASS**

**4 - ADD VEGETATION - A COMBINATION OF BEACH/DUNE GRASS, FALSE HEATHER, SEA LAVENDER, BEACH PLUM, SWEET BAY MAGNOLIA, VIRGINIA ROSE HEDGES, HIGH BUSH BLUEBERRY, MARSH HIBISCUS**

**5 - ADD VEGETATION - A COMBINATION OF BEACH/DUNE GRASS, FALSE HEATHER, SEA LAVENDER, BEACH PLUM, SWEET BAY MAGNOLIA, VIRGINIA ROSE HEDGES, HIGH BUSH BLUEBERRY, MARSH HIBISCUS**

**6 - FENCE REPLACE EXISTING FENCE SHOWN AS THE ---- AROUND THE PERIMETER OF THE PROPERTY ON THE EXISTING FENCE LINE. THE FENCE WILL BE 6' SEMI-PRIVATE ALONG THE BACK LINE OF THE PROPERTY (THE LINE THAT GOES THROUGH THE '5' OVAL). WITH THE REST BEING 4'. NO PARTS OF THE FENCE ARE SOLID**

**VIRGINIA ROSE WILL SURROUND THE INTERIOR PERIMETER OF THE FENCE LINE**

**THE MAJORITY OF THE FENCE IS ON CITY ROADS. WE HAVE A YOUNG CHILD AND DOGS SO FOR SAFETY IT IS NECESSARY**

**4' FENCE**



**6' FENCE**





The Commons  
25 Indian Rock Road • Rte. 111  
Windham, NH 03087  
Tel: (603) 537-0555  
FAX (603) 537-0556

**CONTRACT**

Salesperson: **ADG** Est Date: \_\_\_\_\_ Contract #: \_\_\_\_\_  
 Referred By: \_\_\_\_\_ Est Time: \_\_\_\_\_ Appvd By / Date: \_\_\_\_\_

Bill To: **Bobby Condon**  
**11 76th St**  
**Newburyport, MA 801-5548**

Height	# Feet	Style Fence	Post Style / Size
4' 6"	60'	Danbury Straight	4x4 NE
6'	104'	Imperial White (White)	5x5 NE

- ..... Old Fence
- \_\_\_\_\_ New Fence
- (A) Start
- (T) Tree
- (R) Rock
- (B) Bush

- Take Down
- Take Away
- # Feet \_\_\_\_\_
- Wood
- C/L
- Cement Base

Starting Point: \_\_\_\_\_ Distance from Lot Line: \_\_\_\_\_ Good Side: \_\_\_\_\_  
 Follow Old Fence Line:  Yes  No Level With:  Top Fence  Ground

Step  # Steps \_\_\_\_\_  
 Rack  Grade \_\_\_\_\_

Cor Dia: \_\_\_\_\_ Brace: \_\_\_\_\_ Truss: \_\_\_\_\_ Fittings: \_\_\_\_\_  
 End Dia: \_\_\_\_\_ Mid Rail: \_\_\_\_\_ Alum: \_\_\_\_\_ Steel \_\_\_\_\_  
 Line Dia: \_\_\_\_\_ Bot Rail: \_\_\_\_\_ Barbs: \_\_\_\_\_  
 Top Rail: \_\_\_\_\_ Barbed Wire: \_\_\_\_\_ Power on Site  Yes  No  
 Digger: \_\_\_\_\_ Compressor: \_\_\_\_\_ Concrete: \_\_\_\_\_  
 Yes  No 1st- -2nd \_\_\_\_\_ psi  
 Misc: \_\_\_\_\_

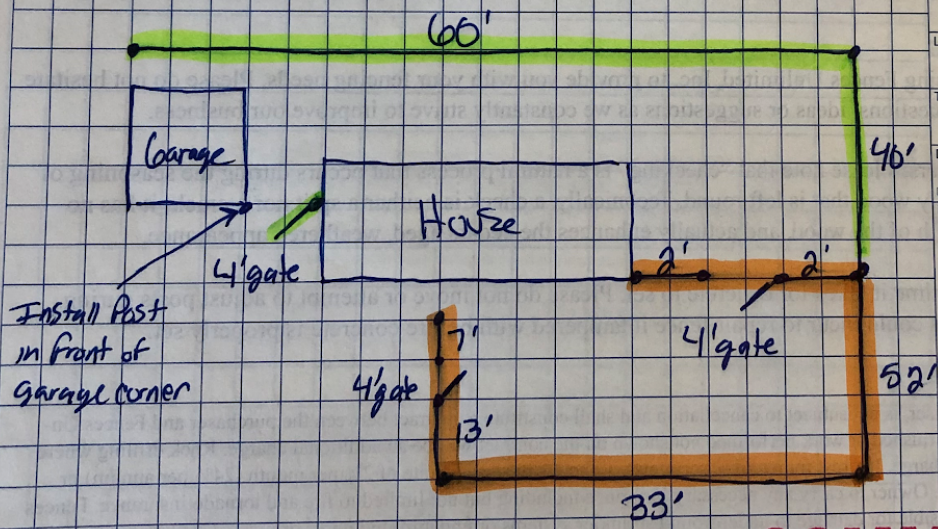

**COMMERCIAL**

#	Gate Type / Size (H x W)	Gate Style / Frame Size	Post Size / Style	Gate Swing	Hinges / Lock	Braces	Truss R
2	Walk / DD / Slide (4x4)	Danbury Straight	4x4 NE	In <input type="radio"/> Out <input type="radio"/> Either			
10	Walk / DD / Slide (6x4)	Imperial	5x5 NE	In <input type="radio"/> Out <input type="radio"/> Either			
	Walk / DD / Slide			In <input type="radio"/> Out <input type="radio"/> Either			

Foreman: \_\_\_\_\_ Date Start: \_\_\_\_\_ Date Finish: \_\_\_\_\_ Actual Footage: \_\_\_\_\_ Customer Approval: \_\_\_\_\_ Customer Paid: \_\_\_\_\_

**7 - ADD AN ARBOR BETWEEN THE FRONT AND BACK YARDS WITH A GATE TO SEPARATE THEM. VIRGINIA ROSE ALONG ENTIRE FENCE.**

**8 - PERGOLA - 10'10' IN SIZE SURROUNDED WITH BEACH AND DUNE GRASS**

**9 - ADD VEGETATION - A COMBINATION OF BEACH/DUNE GRASS, FALSE HEATHER, SEA LAVENDER, BEACH PLUM, SWEET BAY MAGNOLIA, VIRGINIA ROSE HEDGES, HIGH BUSH BLUEBERRY, MARSH HIBISCUS**

**10 - ADD TO BASE OF CRUSHED STONE SAND OR CRUSHED SHELLS, WE ARE FAVORABLE TO WHICHEVER OPTION SUPPORTS THE BEST GROWTH OF MORE BEACH AND DUNE GRASS**