

CITY OF NEWBURYPORT



IN CITY COUNCIL

ORDERED:

July 10, 2023

WHEREAS, on September 27, 2022, the City Council, upon the recommendation of the Community Preservation Committee, appropriated \$2,574,000 by and through ORDR00355_05_09_2022, and

WHEREAS, this appropriation was subject to a final plan being presented to the Council for approval, and

WHEREAS, the plan is in final form without any substantial changes anticipated and is attached hereto and incorporated herewith and marked "Exhibit A".

NOW, THEREFORE, THE CITY COUNCIL OF THE CITY OF NEWBURYPORT hereby approves said plan in accordance with the requirement of ORDR00355_05_09_2022 for the purpose of payment of costs of the Bartlet Mall Frog Pond Improvements project, including the payment of all costs incidental and related thereto.

Councilor Sharif I. Zeid

In City Council July 10, 2023:

Motion to refer to Community Services and COTW by Councillor McCauley, seconded by Councillor Zeid. So voted.

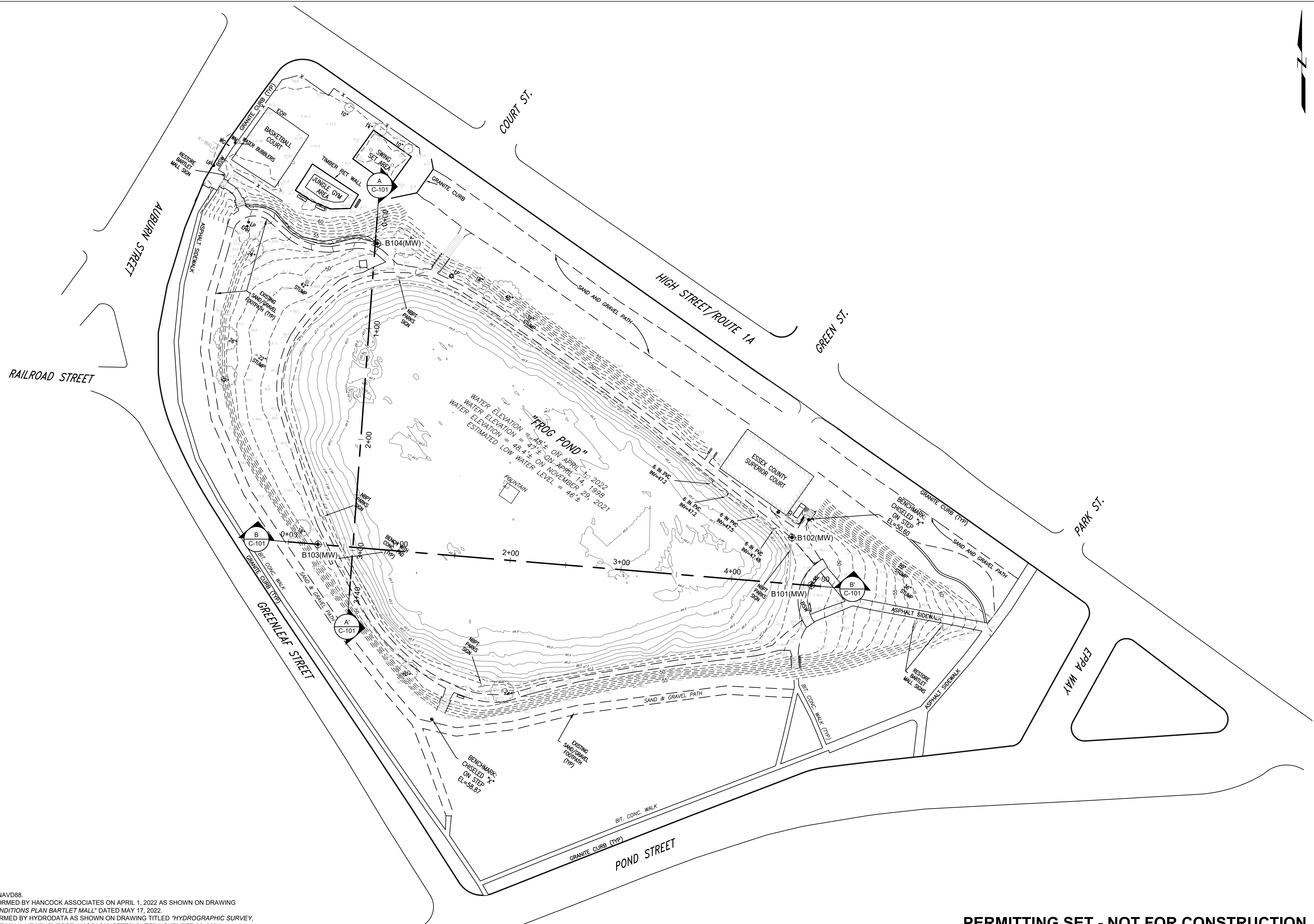

- LEGEND:**
- MONITORING WELL, GEI 2021
 - SEWER MANHOLE
 - DRAIN MANHOLE
 - CATCH BASIN
 - LIGHT POLE
 - UTILITY POLE
 - HYDRANT
 - SIGN
 - TRAFFIC SIGNAL
 - DRINKING FOUNTAIN
 - TC TOP OF CURB
 - BC BOTTOM OF CURB
 - BIT. BITUMINOUS
 - CONC. CONCRETE
 - CLF CHAIN LINK FENCE
 - DECIDUOUS TREE
 - CHAIN LINK FENCE

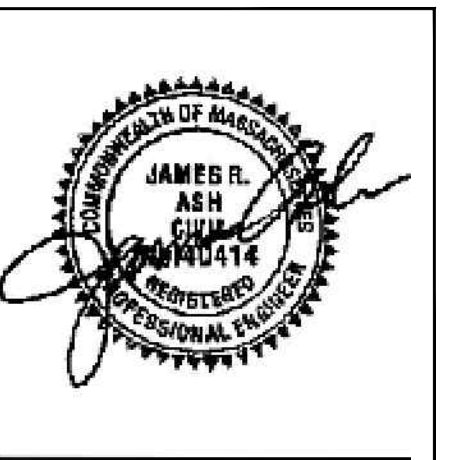

SOURCE:

- ELEVATION DATUM: NAVD88.
- FIELD SURVEY PERFORMED BY HANCOCK ASSOCIATES ON APRIL 1, 2022 AS SHOWN ON DRAWING TITLED "EXISTING CONDITIONS PLAN BARTLET MALL" DATED MAY 17, 2022.
- BATHYMETRY PERFORMED BY HYDRODATA AS SHOWN ON DRAWING TITLED "HYDROGRAPHIC SURVEY, FROG POND, BARTLET MALL, NEWBURYPORT, MASSACHUSETTS" DATED NOVEMBER 29, 2021.

PERMITTING SET - NOT FOR CONSTRUCTION

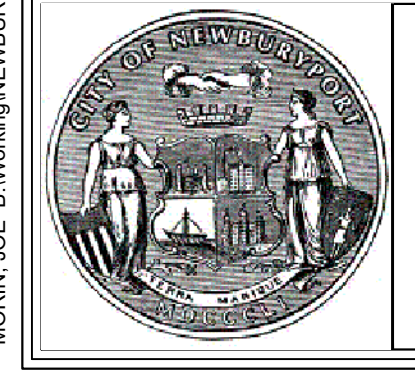

CITY OF NEWBURYPORT
60 PLEASANT STREET
NEWBURYPORT, MA 01950



Rev No	Date	Drawn	Chkd	Description
REVI	06/16/23	D.E.	K.W.	DRAWING SET FOR NOTICE OF INTENT
REVO	04/14/23	D.E.	K.W.	DRAWING SET FOR NOTICE OF INTENT
Revisions				

Designed By:
D.E.
Checked By:
K.W.
Date:
04-14-2023

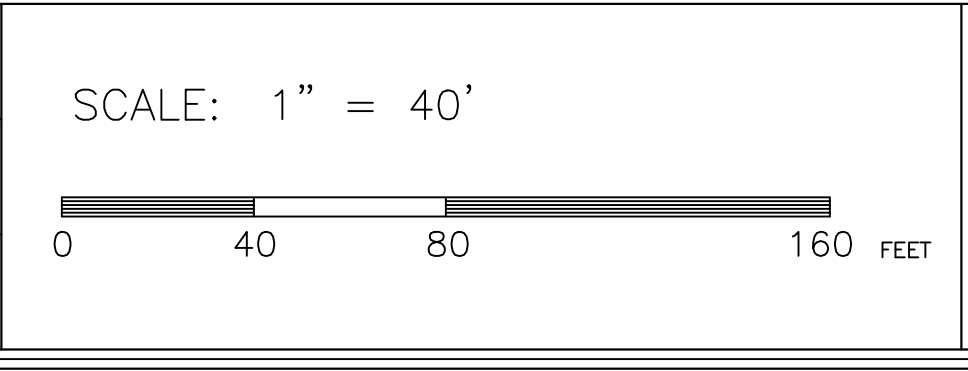

BARTLET MALL RESTORATION PROJECT
EXISTING CONDITIONS

Sheet No.
C-100

MORIN, JOE B. Working\NEWBURYPORT, MA, CITY OF\21013333, Bartlett Mall Frog Pond\00_CADD\Design\GISD\Permit\C-100_21013333-EG.dwg - 6/19/2023

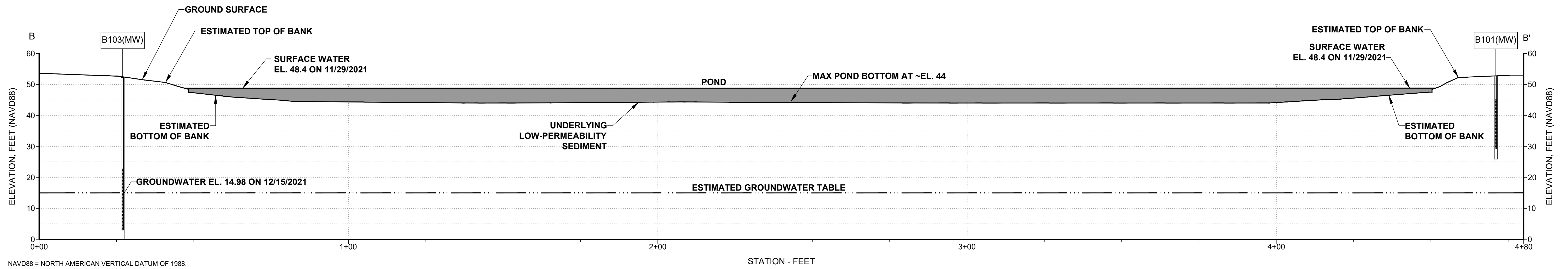
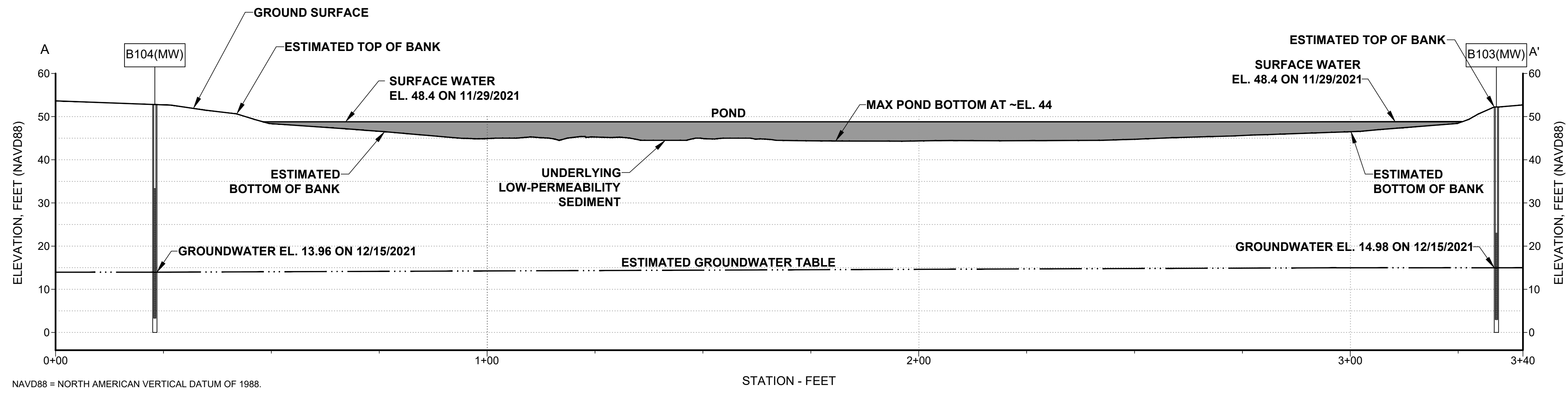

MORIN, JOE B. Working\NEWBURYPORT MA, CITY OF 21013333, Bartlett Mall Frog Pond\00_CAD\Design\Civil\BID\Permit\101_21013333-EC-Sections.dwg - 01/19/2023

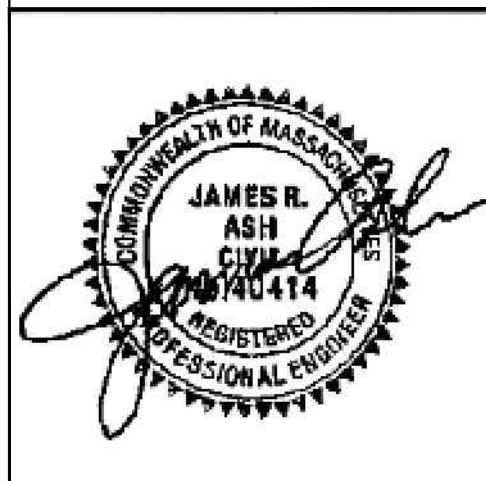



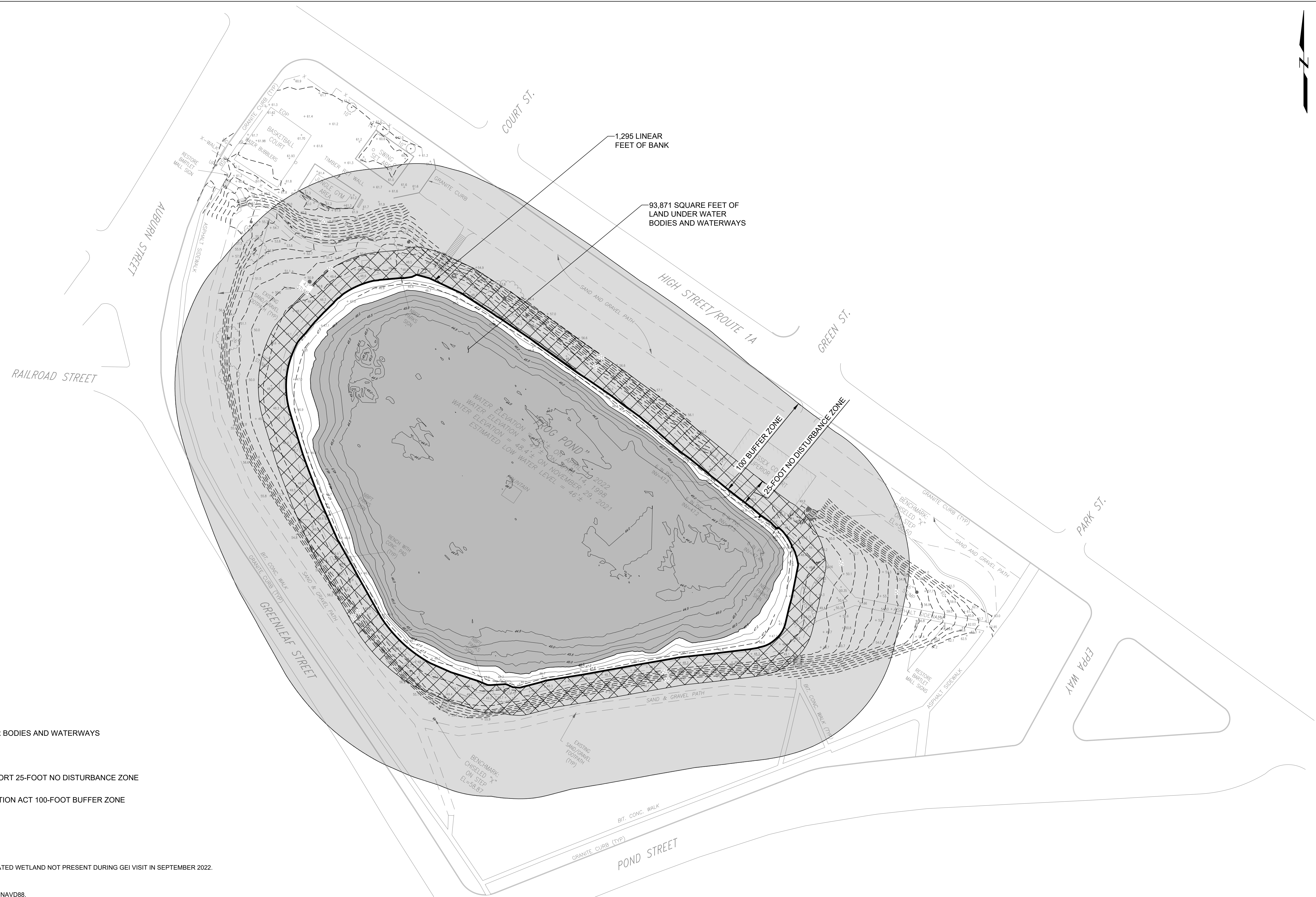

PERMITTING SET - NOT FOR CONSTRUCTION

	CITY OF NEWBURYPORT 60 PLEASANT STREET NEWBURYPORT, MA 01950	GEI Consultants <small>GEI CONSULTANTS, INC. 400 UNICORN PARK DRIVE WOBURN, MA 01801 (781)721-4000</small>										BARTLETT MALL RESTORATION PROJECT EXISTING CONDITIONS SECTIONS	Sheet No.									
			<table border="1" style="width: 100%; border-collapse: collapse;"> <thead> <tr> <th>Rev No</th> <th>Date</th> <th>Drawn</th> <th>Chkd</th> <th>Description</th> </tr> </thead> <tbody> <tr> <td>REVI</td> <td>06/16/23</td> <td>D.E.</td> <td>K.W.</td> <td>DRAWING SET FOR NOTICE OF INTENT</td> </tr> <tr> <td>REVO</td> <td>04/14/23</td> <td>D.E.</td> <td>K.W.</td> <td>DRAWING SET FOR NOTICE OF INTENT</td> </tr> <tr> <td colspan="5" style="text-align: center;">Revisions</td> </tr> </tbody> </table>	Rev No	Date	Drawn	Chkd	Description	REVI	06/16/23	D.E.		K.W.	DRAWING SET FOR NOTICE OF INTENT	REVO	04/14/23	D.E.	K.W.	DRAWING SET FOR NOTICE OF INTENT	Revisions		
Rev No	Date	Drawn	Chkd	Description																		
REVI	06/16/23	D.E.	K.W.	DRAWING SET FOR NOTICE OF INTENT																		
REVO	04/14/23	D.E.	K.W.	DRAWING SET FOR NOTICE OF INTENT																		
Revisions																						

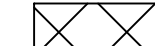

LEGEND:

-  APPROXIMATE LAND UNDER WATER BODIES AND WATERWAYS
-  TOP OF BANK
-  APPROXIMATE CITY OF NEWBURYPORT 25-FOOT NO DISTURBANCE ZONE
-  APPROXIMATE WETLANDS PROTECTION ACT 100-FOOT BUFFER ZONE

NOTES:

1. BORDERING VEGETATED WETLAND NOT PRESENT DURING GEI VISIT IN SEPTEMBER 2022.

SOURCE:

1. ELEVATION DATUM: NAVD88.
2. FIELD SURVEY PERFORMED BY HANCOCK ASSOCIATES ON APRIL 1, 2022 AS SHOWN ON DRAWING TITLED "EXISTING CONDITIONS PLAN BARTLET MALL" DATED MAY 17, 2022.
3. BATHYMETRY PERFORMED BY HYDRODATA AS SHOWN ON DRAWING TITLED "HYDROGRAPHIC SURVEY, FROG POND, BARTLET MALL, NEWBURYPORT, MASSACHUSETTS" DATED NOVEMBER 29, 2021.

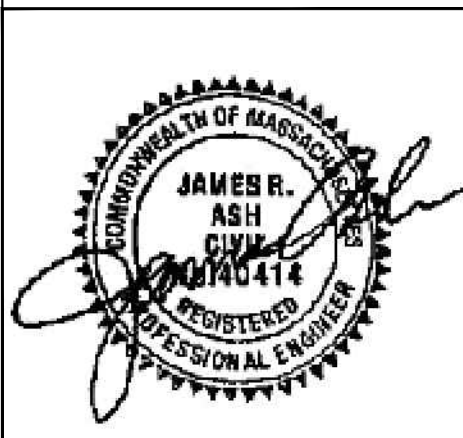

PERMITTING SET - NOT FOR CONSTRUCTION

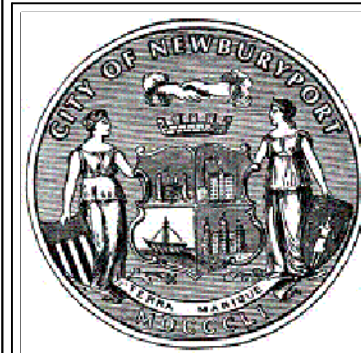

CITY OF NEWBURYPORT
60 PLEASANT STREET
NEWBURYPORT, MA 01950



Rev No	Date	Drawn	Chkd	Description
REVI	06/16/23	D.E.	K.W.	DRAWING SET FOR NOTICE OF INTENT
REVO	04/14/23	D.E.	K.W.	DRAWING SET FOR NOTICE OF INTENT
Revisions				

Designed By:
D.E.
Checked By:
K.W.
Date:
04-14-2023

SCALE: 1" = 40'

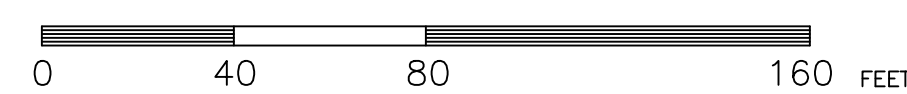

BARTLET MALL RESTORATION PROJECT

RESOURCE AREAS

Sheet No.

C-102

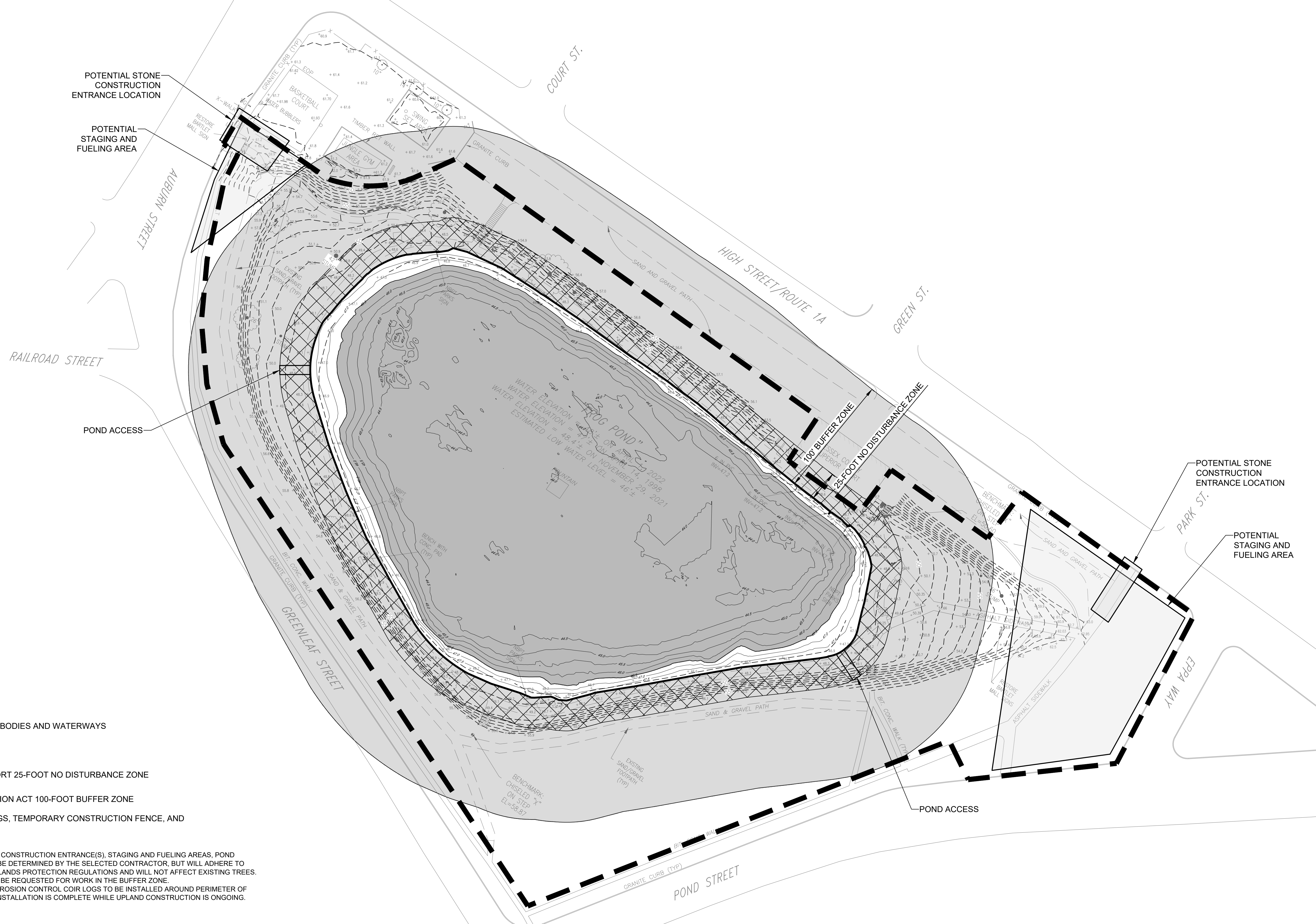
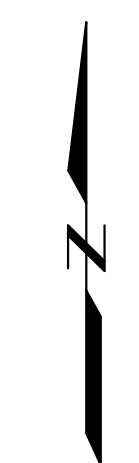

POTENTIAL STONE CONSTRUCTION ENTRANCE LOCATION

POTENTIAL STAGING AND FUELING AREA

POND ACCESS

POTENTIAL STONE CONSTRUCTION ENTRANCE LOCATION

POTENTIAL STAGING AND FUELING AREA

POND ACCESS

LEGEND:

- APPROXIMATE LAND UNDER WATER BODIES AND WATERWAYS
- TOP OF BANK
- APPROXIMATE CITY OF NEWBURYPORT 25-FOOT NO DISTURBANCE ZONE
- APPROXIMATE WETLANDS PROTECTION ACT 100-FOOT BUFFER ZONE
- 6-INCH EROSION CONTROL COIR LOGS, TEMPORARY CONSTRUCTION FENCE, AND LIMIT OF WORK

NOTES:

1. FINAL LOCATIONS OF CONSTRUCTION ENTRANCE(S), STAGING AND FUELING AREAS, POND ACCESSES, ETC. TO BE DETERMINED BY THE SELECTED CONTRACTOR, BUT WILL ADHERE TO NEWBURYPORT WETLANDS PROTECTION REGULATIONS AND WILL NOT AFFECT EXISTING TREES. LETTER PERMIT WILL BE REQUESTED FOR WORK IN THE BUFFER ZONE.
2. ADDITIONAL 6-INCH EROSION CONTROL COIR LOGS TO BE INSTALLED AROUND PERIMETER OF POND AFTER LINER INSTALLATION IS COMPLETE WHILE UPLAND CONSTRUCTION IS ONGOING.

SOURCE:

1. ELEVATION DATUM: NAVD88.
2. FIELD SURVEY PERFORMED BY HANCOCK ASSOCIATES ON APRIL 1, 2022 AS SHOWN ON DRAWING TITLED "EXISTING CONDITIONS PLAN BARTLET MALL" DATED MAY 17, 2022.
3. BATHYMETRY PERFORMED BY HYDRODATA AS SHOWN ON DRAWING TITLED "HYDROGRAPHIC SURVEY, FROG POND, BARTLET MALL, NEWBURYPORT, MASSACHUSETTS" DATED NOVEMBER 29, 2021.

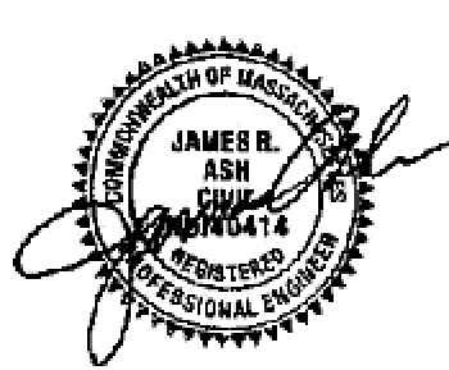

PERMITTING SET - NOT FOR CONSTRUCTION

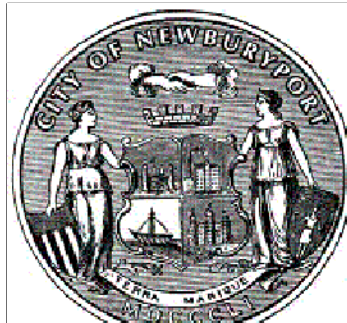

CITY OF NEWBURYPORT
60 PLEASANT STREET
NEWBURYPORT, MA 01950



Rev No	Date	Drawn	Chkd	Description
REVI	06/16/23	D.E.	K.W.	DRAWING SET FOR NOTICE OF INTENT
REVO	04/14/23	D.E.	K.W.	DRAWING SET FOR NOTICE OF INTENT
Revisions				

Designed By:
D.E.
Checked By:
K.W.
Date:
04-14-2023

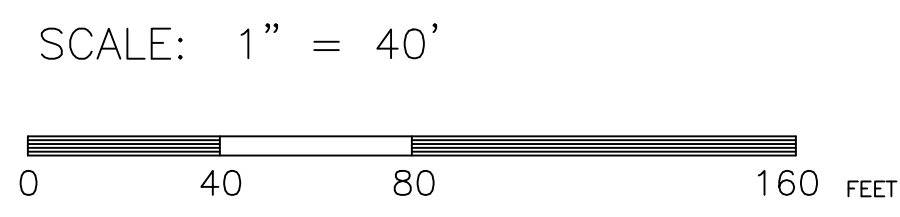

BARTLET MALL RESTORATION PROJECT
STAGING AND EROSION CONTROL PLAN

Sheet No.
C-103

MORIN, JOE B: WorkingNEWBURYPORT MA CITY OF2101333 Bartlett Mall Frog Pond00_CADDDesign\GISD\PermitC-103 2101333 Staging and Erosion Control Plan.dwg - 6/19/2023

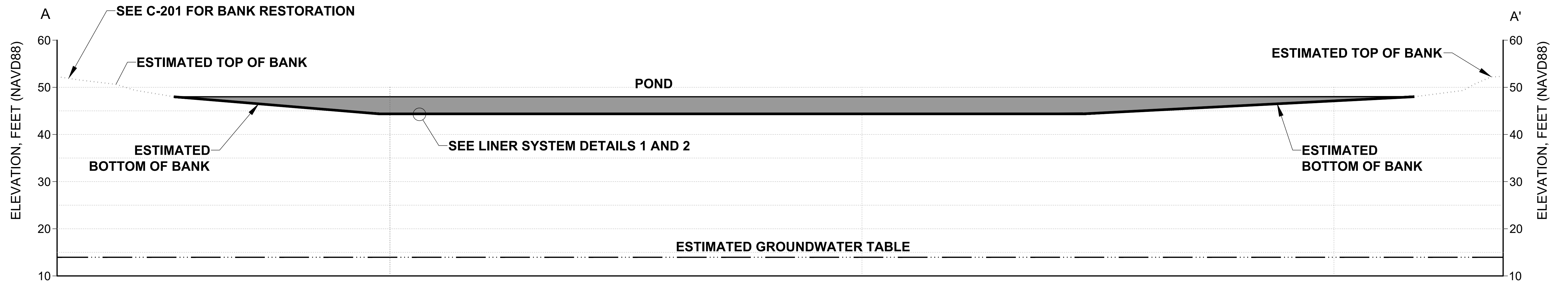

NAVD88 = NORTH AMERICAN VERTICAL DATUM OF 1988.

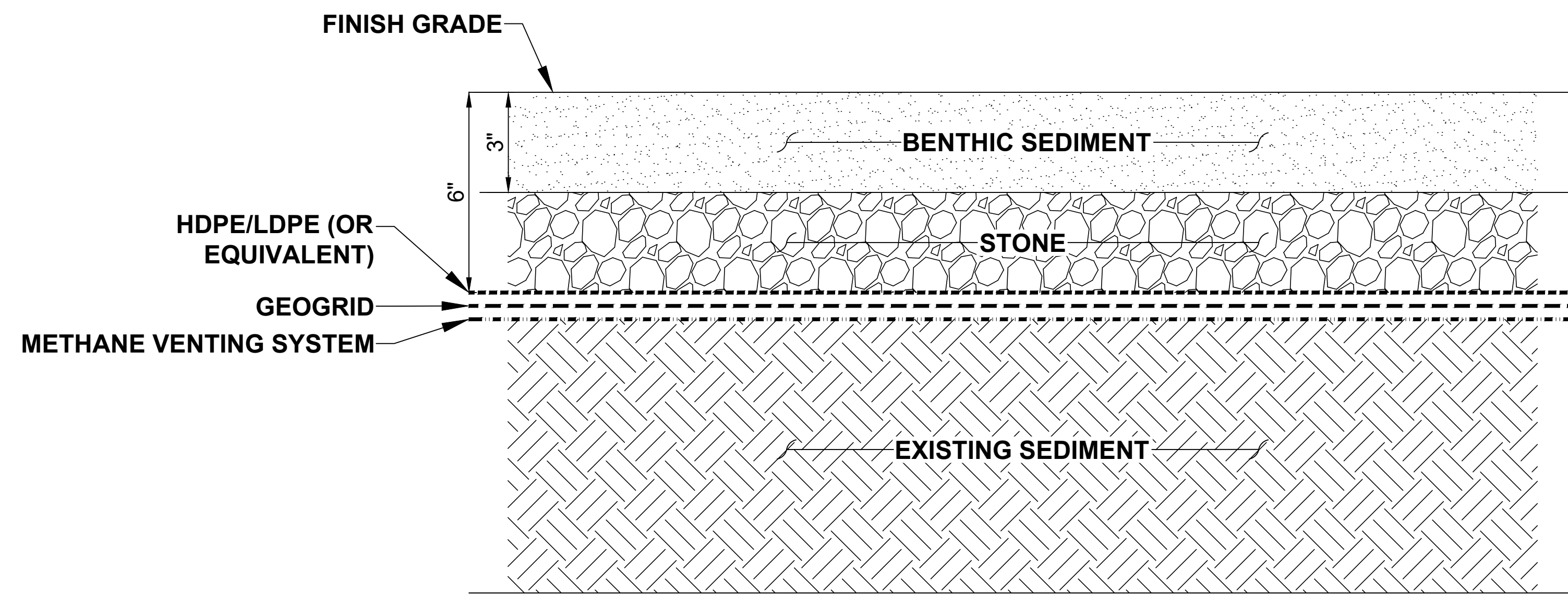

1 TYPICAL DETAIL
C-104 LINER SYSTEM DETAIL NO SCALE

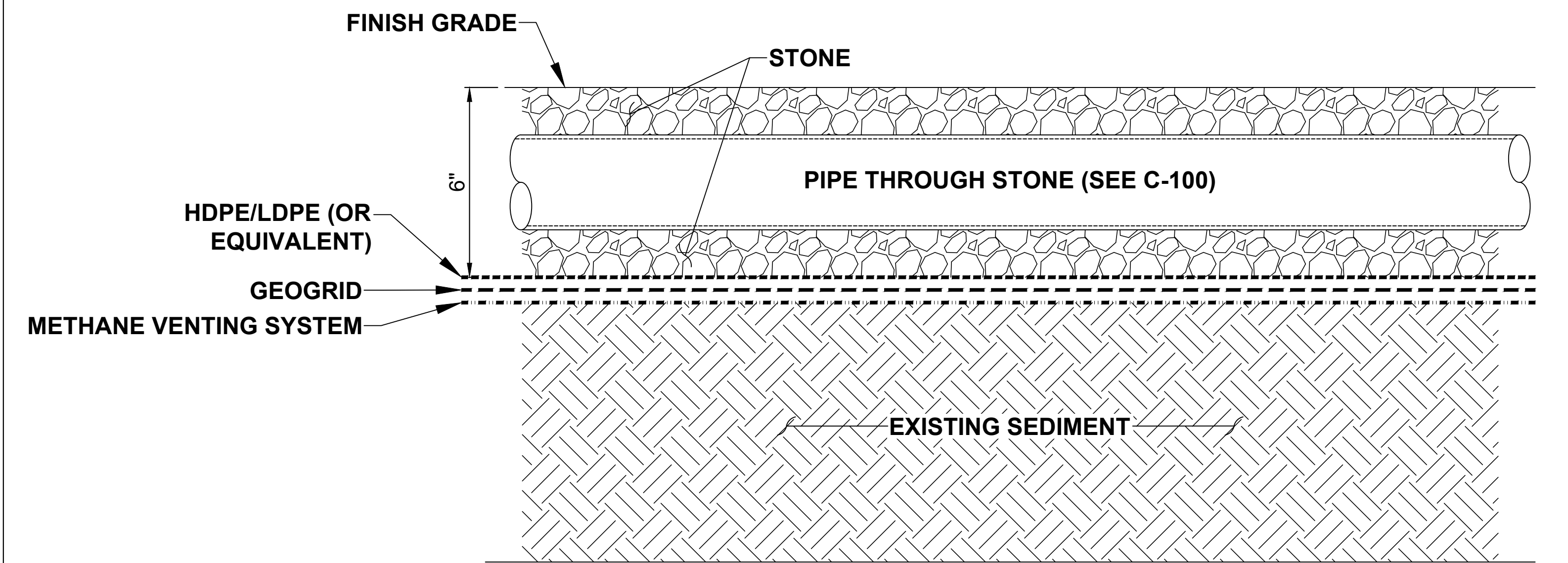

2 TYPICAL DETAIL
C-104 LINER SYSTEM DETAIL AROUND WATER QUALITY PIPES NO SCALE

MORIN, JOE B. WorkingNEWBURYPORT MA, CITY OF 2101333, Bartlett Mall Frog Pond00_CADDDesign/Ch/ISD/Permit/C-200 2101333-Liner.dwg - 01/19/2023

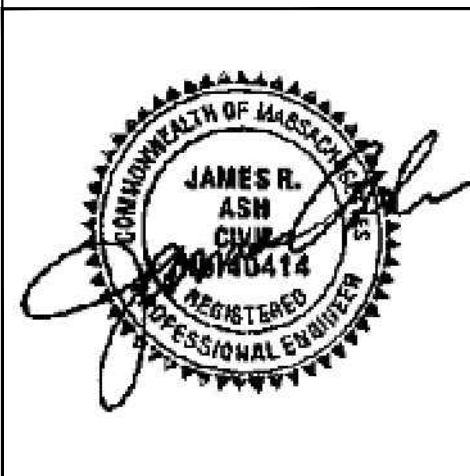

PERMITTING SET - NOT FOR CONSTRUCTION

	CITY OF NEWBURYPORT 60 PLEASANT STREET NEWBURYPORT, MA 01950					Designed By: D.E.	BARTLETT MALL RESTORATION PROJECT LINER SYSTEM SECTION AND DETAILS	Sheet No. C-200															
			<table border="1" style="width: 100%; border-collapse: collapse;"> <thead> <tr> <th>Rev No</th> <th>Date</th> <th>Drawn</th> <th>Chkd</th> <th>Description</th> </tr> </thead> <tbody> <tr> <td>REVI</td> <td>06/16/23</td> <td>D.E.</td> <td>K.W.</td> <td>DRAWING SET FOR NOTICE OF INTENT</td> </tr> <tr> <td>REVO</td> <td>04/14/23</td> <td>D.E.</td> <td>K.W.</td> <td>DRAWING SET FOR NOTICE OF INTENT</td> </tr> <tr> <td colspan="5" style="text-align: center;">Revisions</td> </tr> </tbody> </table>	Rev No	Date	Drawn			Chkd	Description	REVI	06/16/23	D.E.	K.W.	DRAWING SET FOR NOTICE OF INTENT	REVO	04/14/23	D.E.	K.W.	DRAWING SET FOR NOTICE OF INTENT	Revisions		
Rev No	Date	Drawn	Chkd	Description																			
REVI	06/16/23	D.E.	K.W.	DRAWING SET FOR NOTICE OF INTENT																			
REVO	04/14/23	D.E.	K.W.	DRAWING SET FOR NOTICE OF INTENT																			
Revisions																							
Checked By: K.W.																							
Date: 04-14-2023																							

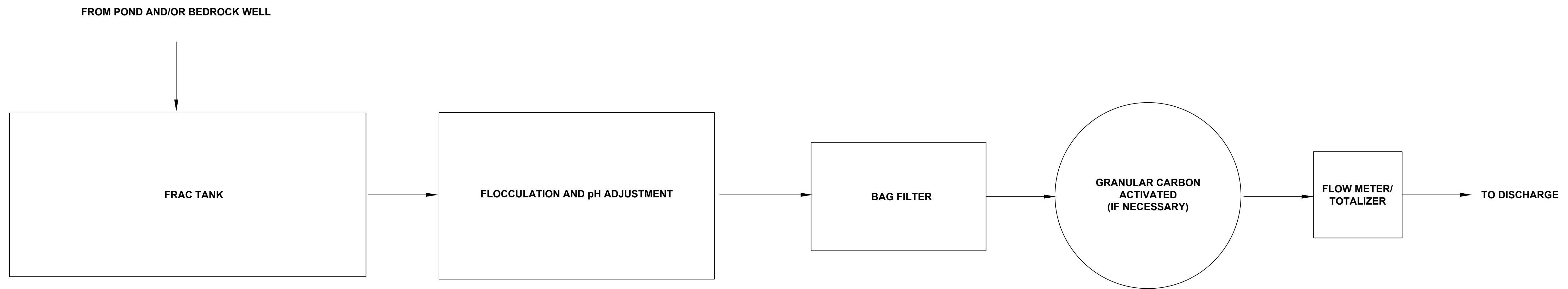

PROCESS FLOW DIAGRAM
NO SCALE

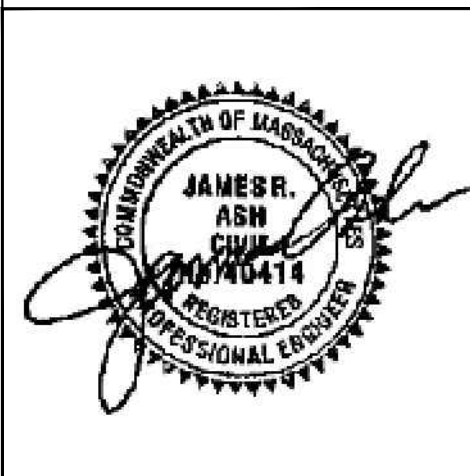

NOTES:
1. NPDES = NATIONAL POLLUTANT DISCHARGE ELIMINATION SYSTEM.

PERMITTING SET - NOT FOR CONSTRUCTION

MORIN, JOE B. Working\NEWBURYPORT MA_CITY OF 2101333_Bartlett Mall Frog Pond\00_CADD\Design\Civil\ISD\Permit\C-300_2101333-Flow.dwg - 01/18/2023

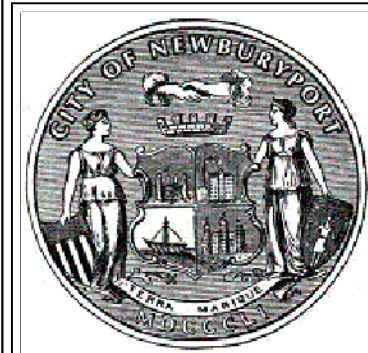

CITY OF NEWBURYPORT
60 PLEASANT STREET
NEWBURYPORT, MA 01950



Rev No	Date	Drawn	Chkd	Description
REVI	06/16/23	D.E.	K.W.	DRAWING SET FOR NOTICE OF INTENT
REVO	04/14/23	D.E.	K.W.	DRAWING SET FOR NOTICE OF INTENT
Revisions				

Designed By:
D.E.
Checked By:
K.W.
Date:
04-14-2023

**BARTLET MALL RESTORATION PROJECT
NPDES WATER TREATMENT
SYSTEM PROCESS FLOW
DIAGRAM**

Sheet No.

C-300

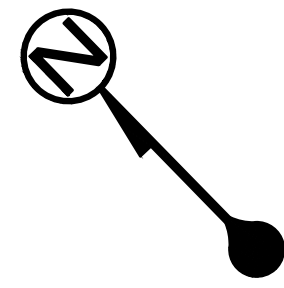

LEGEND

- CRUSHED STONE PATH
- FLEXIPAVE WALKWAY
- VEGETATED PERIMETER
- GRANITE SEAT-HEIGHT BLOCKS
- PROPOSED POND ACCESS POINT
- BEDROCK WELL LINE
- DOMESTIC WATER LINE
- ELECTRICAL SERVICE
- DISCHARGE AND AERATION LINE
- RECIRCULATED WATER LINE
- PUMP INTAKE PIPE
- DRYWELL DRAIN PIPE
- SURFACE WATER (APPROXIMATE)

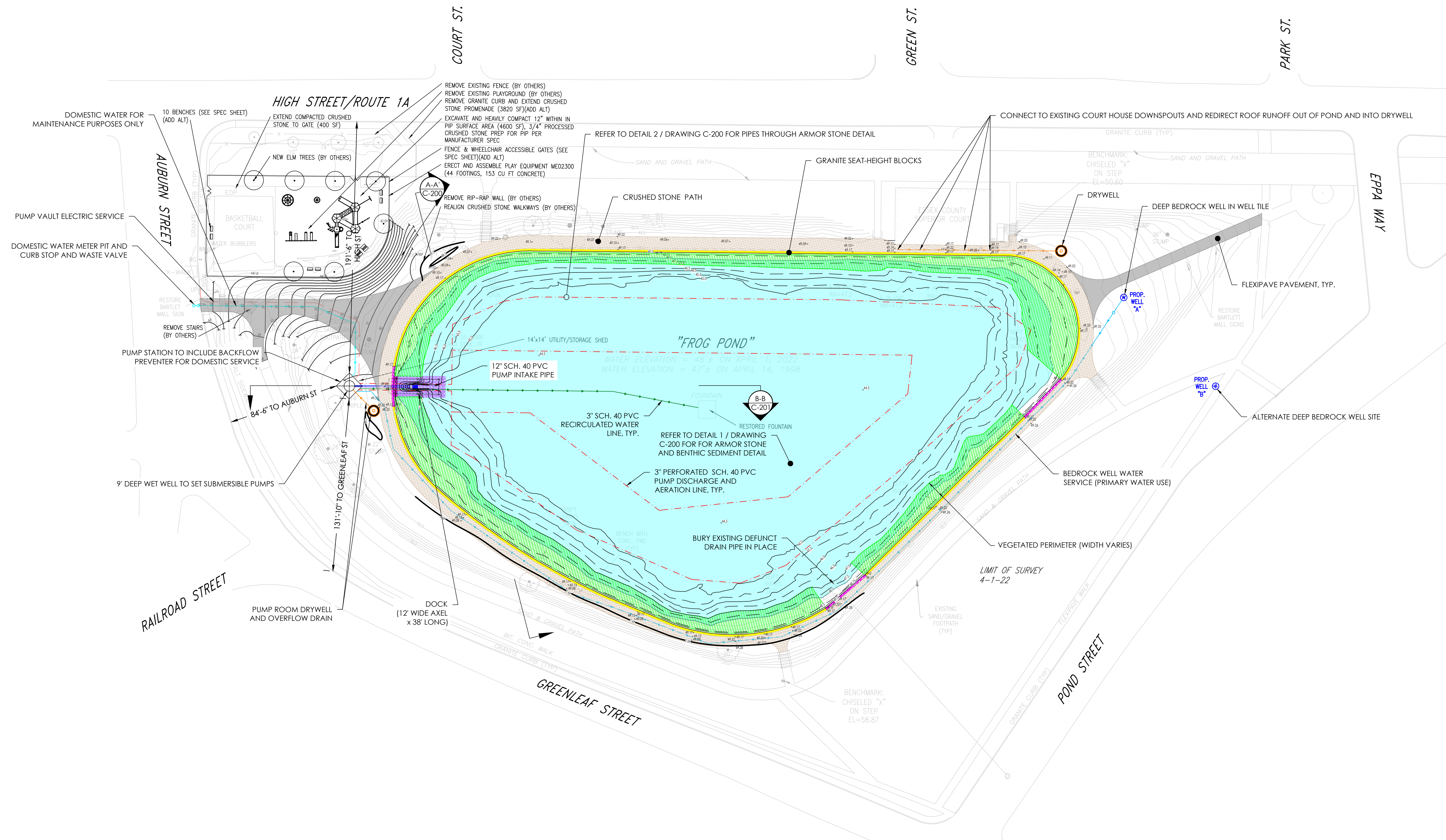

DESIGN BY:

AQUEOUS CONSULTANTS, LLC
 1 Dundee Park Drive, Suite 10
 Andover, MA 01810
 (978) 470-1695
 www.aqueous.net

Know what's below.
Call before you dig.

Michael Igo
6/19/23

PERMITTING SET - NOT FOR CONSTRUCTION

	CITY OF NEWBURYPORT 60 PLEASANT STREET NEWBURYPORT, MA 01950		Designed By: A. Hammond Checked By: M. Igo Date: 4-14-2023	SCALE: PLAN Scale: 1" = 40' 	BARTLET MALL RESTORATION PROJECT PROPOSED FINAL CONDITIONS	Sheet No. C-104

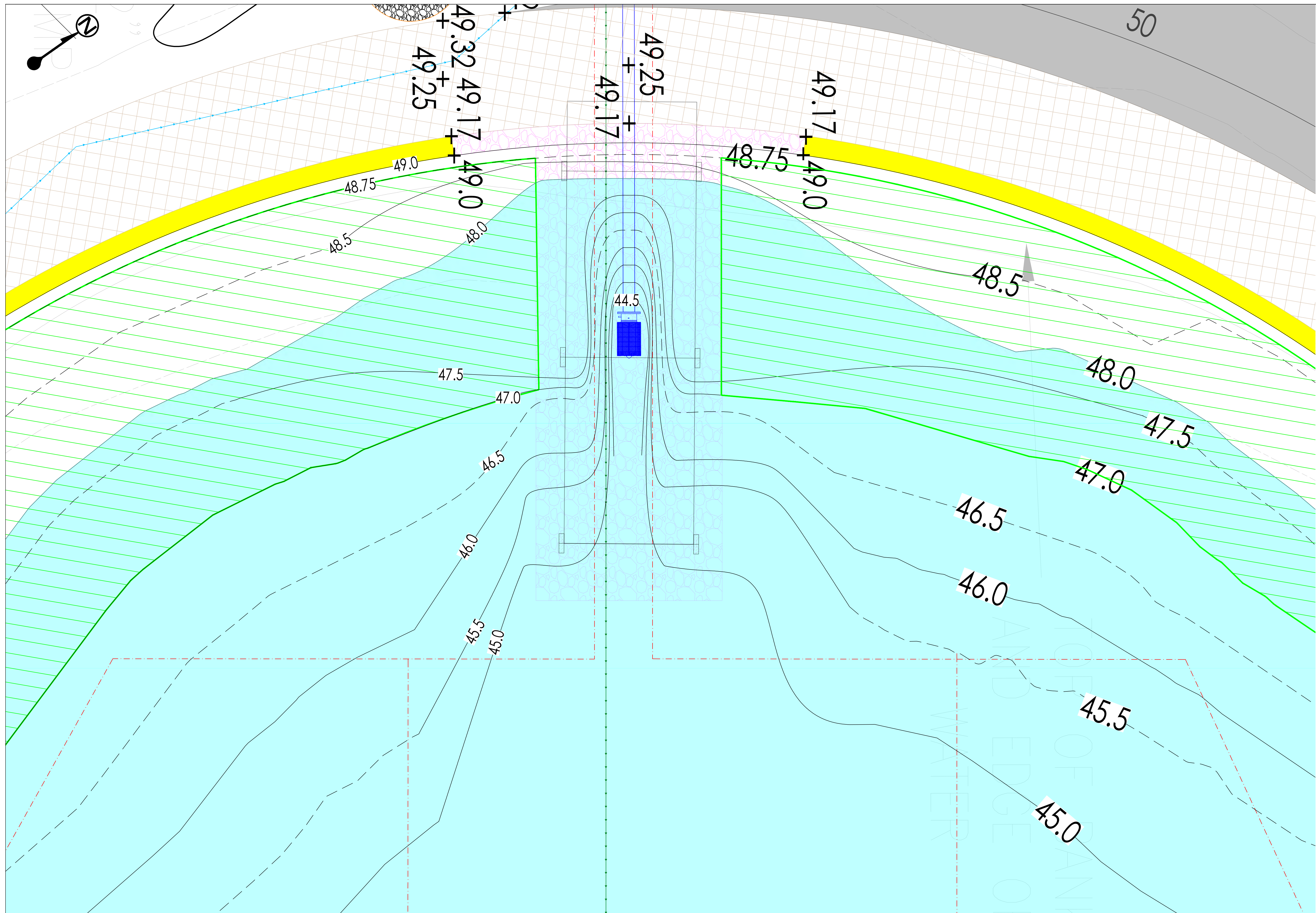

LEGEND

- CRUSHED STONE PATH
- FLEXIPAVE WALKWAY
- VEGETATED PERIMETER
- GRANITE SEAT-HEIGHT BLOCKS
- PROPOSED POND ACCESS POINT
- BEDROCK WELL LINE
- DOMESTIC WATER LINE
- ELECTRICAL SERVICE
- DISCHARGE AND AERATION LINE
- RECIRCULATED WATER LINE
- PUMP INTAKE PIPE
- DRYWELL DRAIN PIPE
- SURFACE WATER (APPROXIMATE)

DESIGN BY:



AQUEOUS CONSULTANTS, LLC
 1 Dundee Park Drive, Suite 10
 Andover, MA 01810
 (978) 470-1695
 www.aqueous.net



Know what's below.
 Call before you dig.



Michael Igo
 6/19/23

PERMITTING SET - NOT FOR CONSTRUCTION



CITY OF NEWBURYPORT
 60 PLEASANT STREET
 NEWBURYPORT, MA 01950

Rev No	Date	Drawn	Chkd	Description
REV 1	6/19/23	AEH	MI	DRAWING SET FOR NOTICE OF INTENT
REV 0	4/14/23	AEH	MI	DRAWING SET FOR NOTICE OF INTENT
Revisions				

Designed By:
 A. Hammond
 Checked By:
 M. Igo
 Date:
 4-14-2023

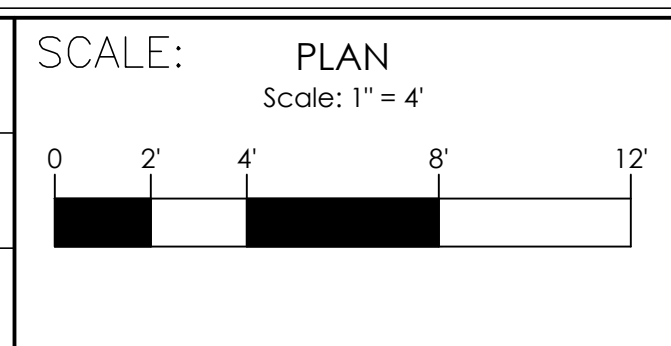

BARTLET MALL RESTORATION PROJECT
PROPOSED FINAL CONDITIONS

Sheet No.
C-104A

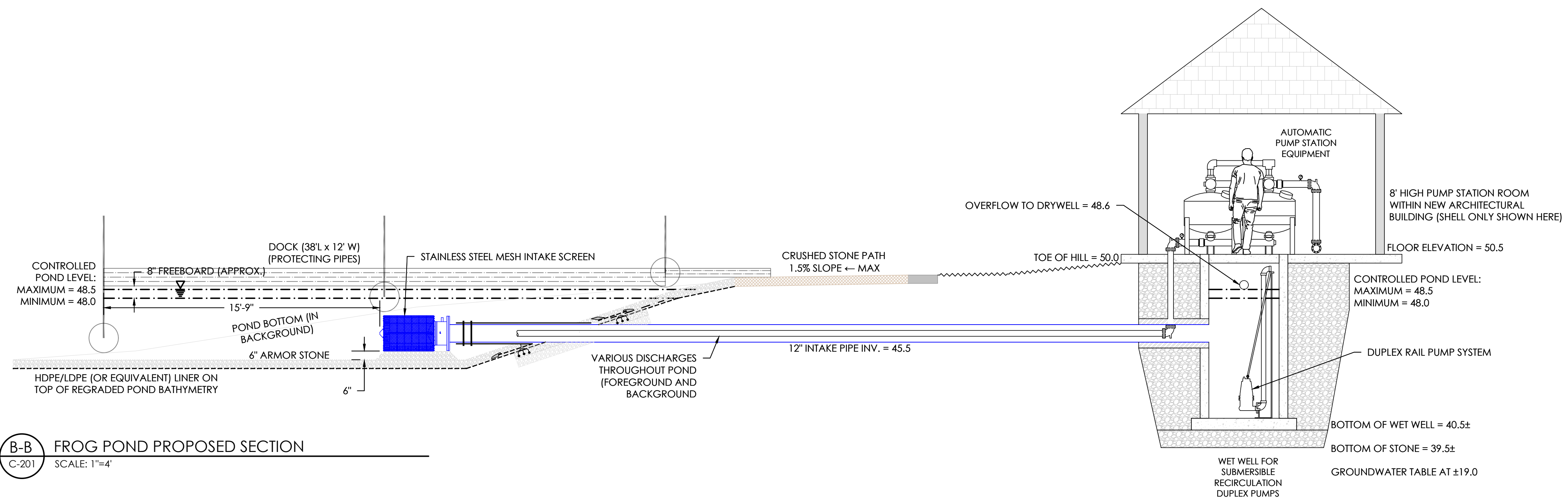

B-B FROG POND PROPOSED SECTION
C-201 SCALE: 1"=4'

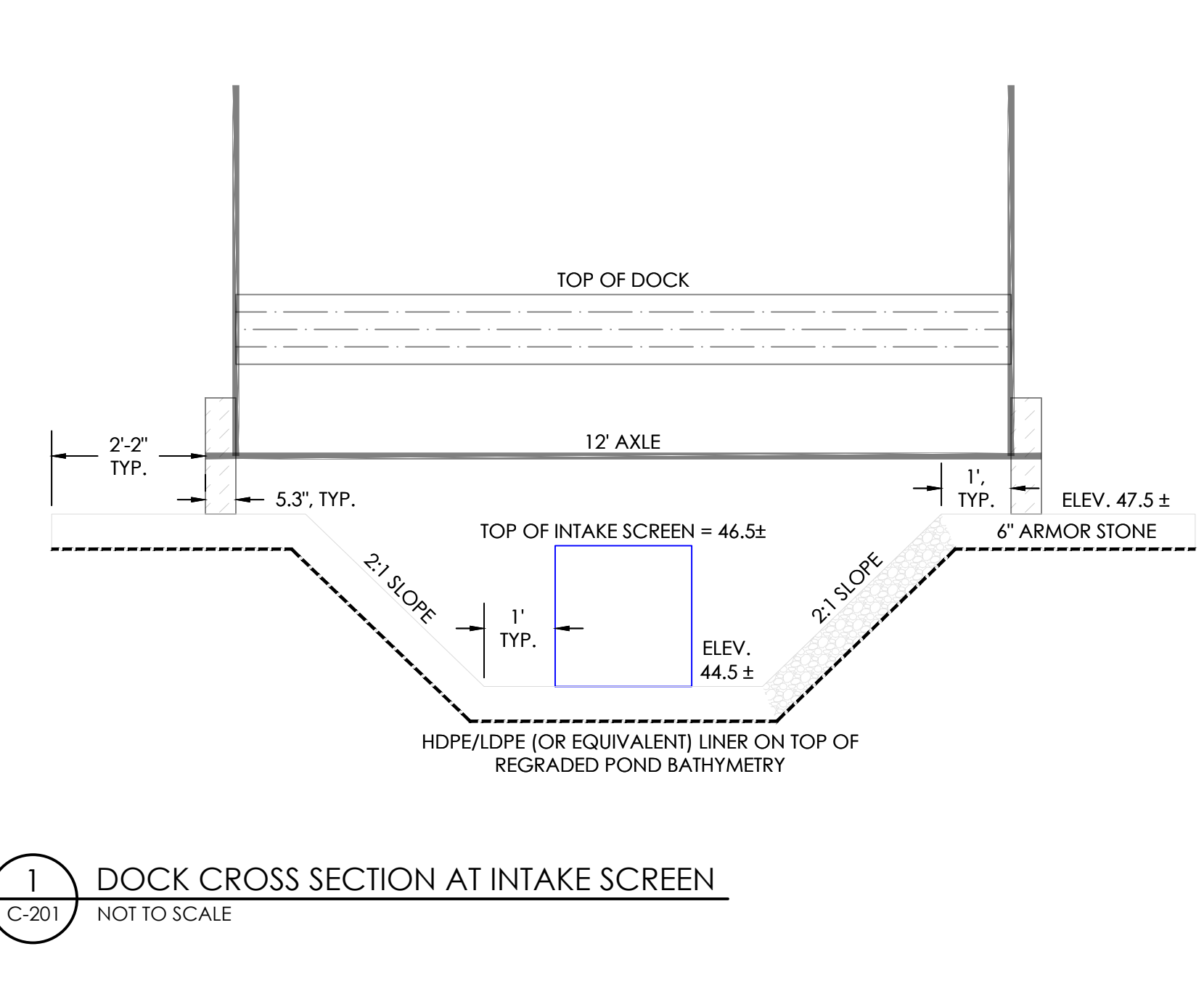

1 DOCK CROSS SECTION AT INTAKE SCREEN
C-201 NOT TO SCALE

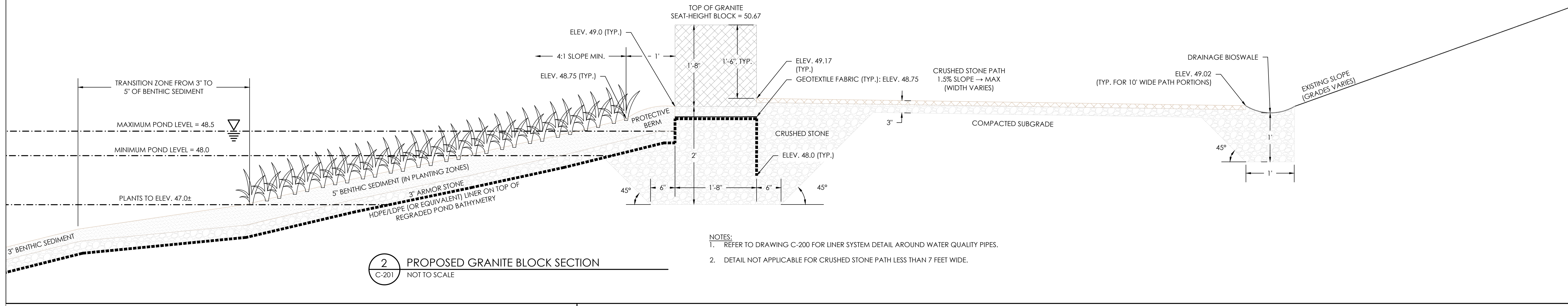

2 PROPOSED GRANITE BLOCK SECTION
C-201 NOT TO SCALE

- NOTES:
1. REFER TO DRAWING C-200 FOR LINER SYSTEM DETAIL AROUND WATER QUALITY PIPES.
2. DETAIL NOT APPLICABLE FOR CRUSHED STONE PATH LESS THAN 7 FEET WIDE.

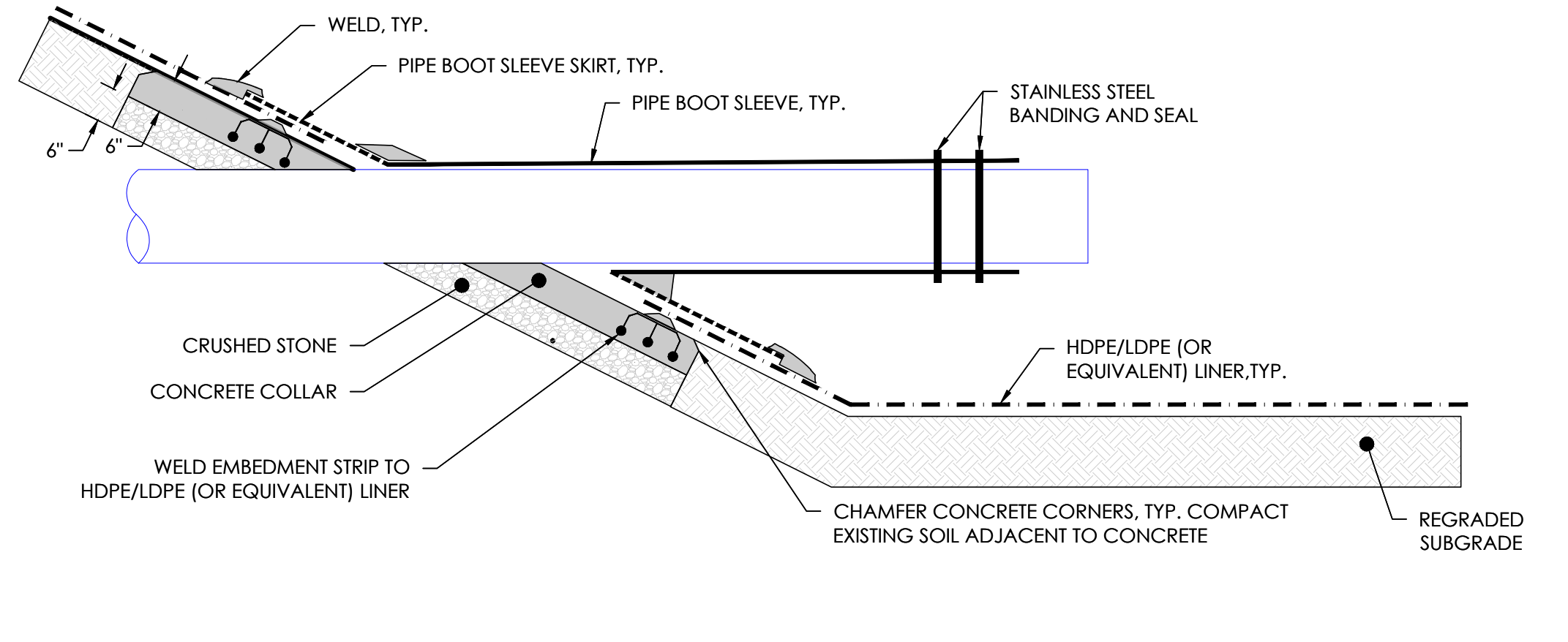

3 TYPICAL PIPE PENETRATION THROUGH HDPE LINER
C-201 NOT TO SCALE

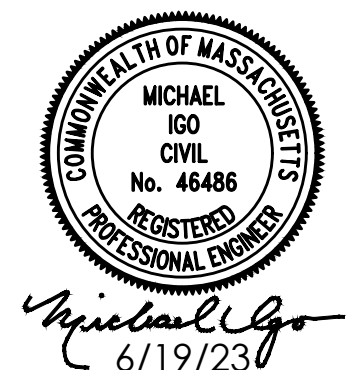

Michael Igo
6/19/23

PERMITTING SET - NOT FOR CONSTRUCTION



CITY OF NEWBURYPORT
60 PLEASANT STREET
NEWBURYPORT, MA 01950

Rev No	Date	Drawn	Chkd	Description
REV 1	6/19/23	AEH	MI	DRAWING SET FOR NOTICE OF INTENT
REV 0	4/14/23	AEH	MI	DRAWING SET FOR NOTICE OF INTENT
Revisions				

Designed By:
A. Hammond
Checked By:
M. Igo
Date:
4-14-2023

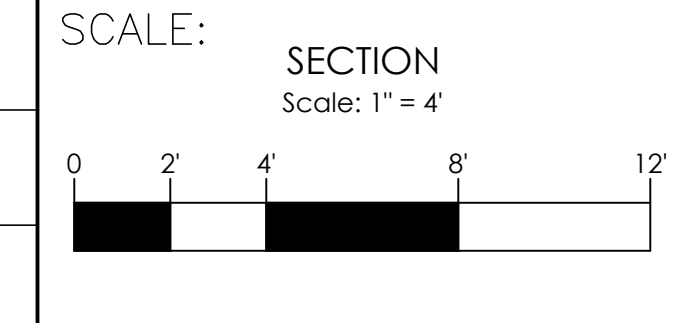

BARTLET MALL RESTORATION PROJECT

CIVIL DETAILS - 1

Sheet No.

C-201

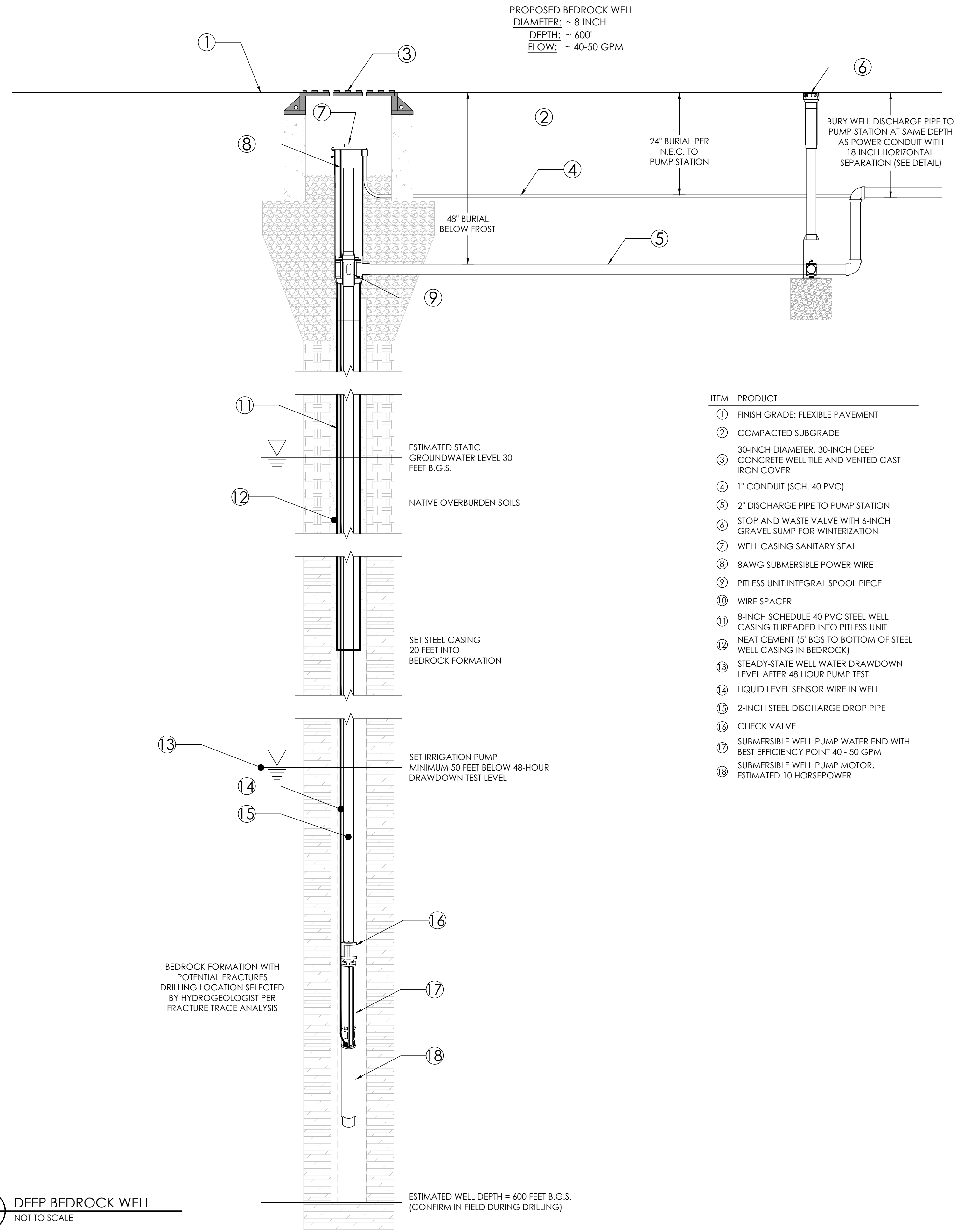

NOTE:
 1. BEDROCK WELL WATER TO BE TESTED TO EPA WATER QUALITY STANDARDS.

ITEM	PRODUCT
①	FINISH GRADE: FLEXIBLE PAVEMENT
②	COMPACTED SUBGRADE
③	30-INCH DIAMETER, 30-INCH DEEP CONCRETE WELL TILE AND VENTED CAST IRON COVER
④	1" CONDUIT (SCH. 40 PVC)
⑤	2" DISCHARGE PIPE TO PUMP STATION
⑥	STOP AND WASTE VALVE WITH 6-INCH GRAVEL SUMP FOR WINTERIZATION
⑦	WELL CASING SANITARY SEAL
⑧	8AWG SUBMERSIBLE POWER WIRE
⑨	PITLESS UNIT INTEGRAL SPOOL PIECE
⑩	WIRE SPACER
⑪	8-INCH SCHEDULE 40 PVC STEEL WELL CASING THREADED INTO PITLESS UNIT
⑫	NEAT CEMENT (5 BGS TO BOTTOM OF STEEL WELL CASING IN BEDROCK)
⑬	STEADY-STATE WELL WATER DRAWDOWN LEVEL AFTER 48 HOUR PUMP TEST
⑭	LIQUID LEVEL SENSOR WIRE IN WELL
⑮	2-INCH STEEL DISCHARGE DROP PIPE
⑯	CHECK VALVE
⑰	SUBMERSIBLE WELL PUMP WATER END WITH BEST EFFICIENCY POINT 40 - 50 GPM
⑱	SUBMERSIBLE WELL PUMP MOTOR, ESTIMATED 10 HORSEPOWER

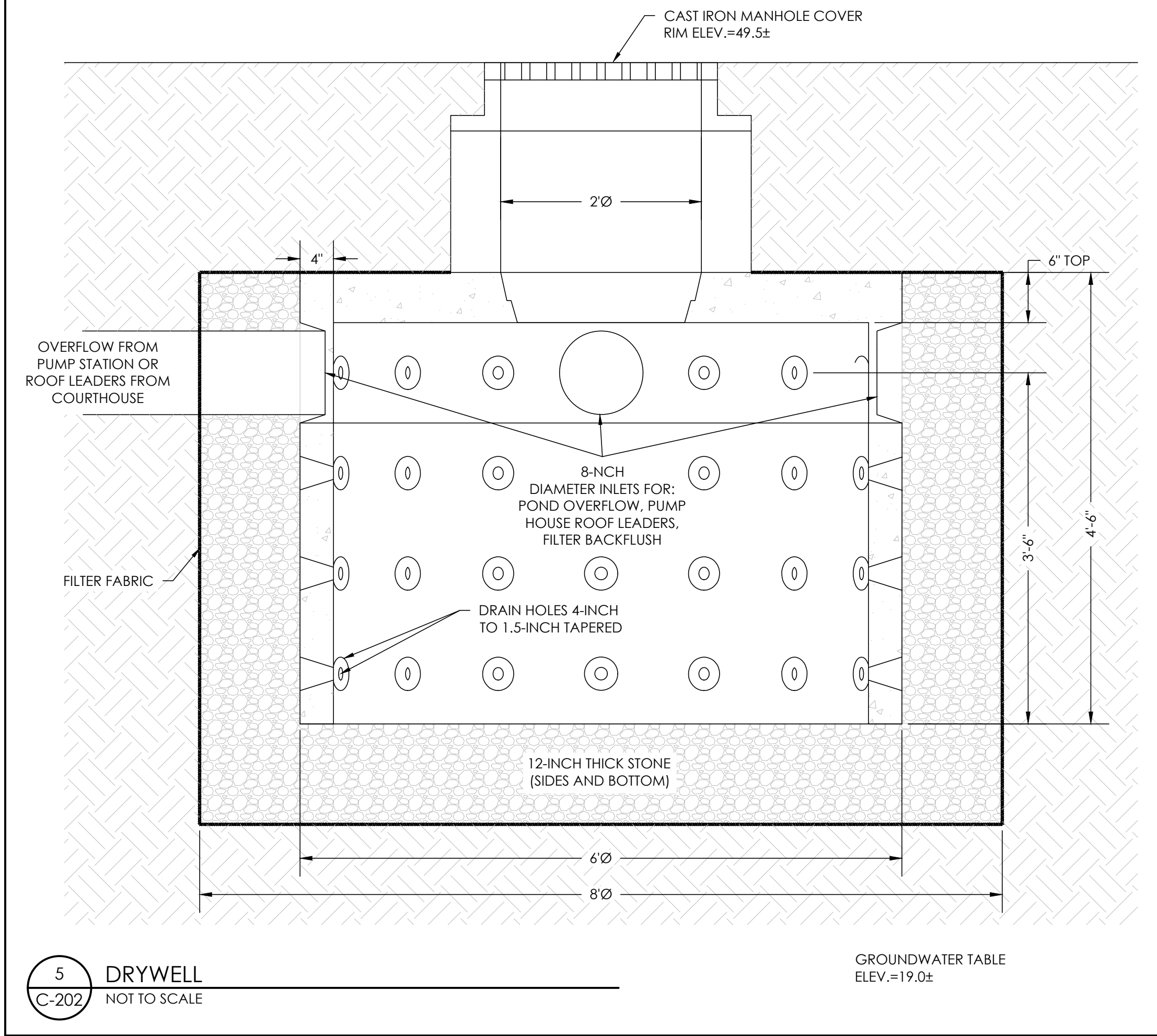

4 DEEP BEDROCK WELL
 C-202 NOT TO SCALE

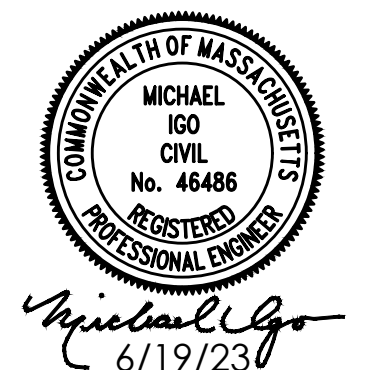

PERMITTING SET - NOT FOR CONSTRUCTION

<p>CITY OF NEWBURYPORT 60 PLEASANT STREET NEWBURYPORT, MA 01950</p>	REV 16/19/23 AEH MI DRAWING SET FOR NOTICE OF INTENT REV 04/14/23 AEH MI DRAWING SET FOR NOTICE OF INTENT Rev No Date Drawn Chkd Description Revisions	Designed By: A. Hammond Checked By: M. Igo Date: 4-14-2023	SCALE: AS SHOWN	BARTLET MALL RESTORATION PROJECT CIVIL DETAILS - 2	Sheet No. C-202
---	--	--	-----------------	---	--------------------

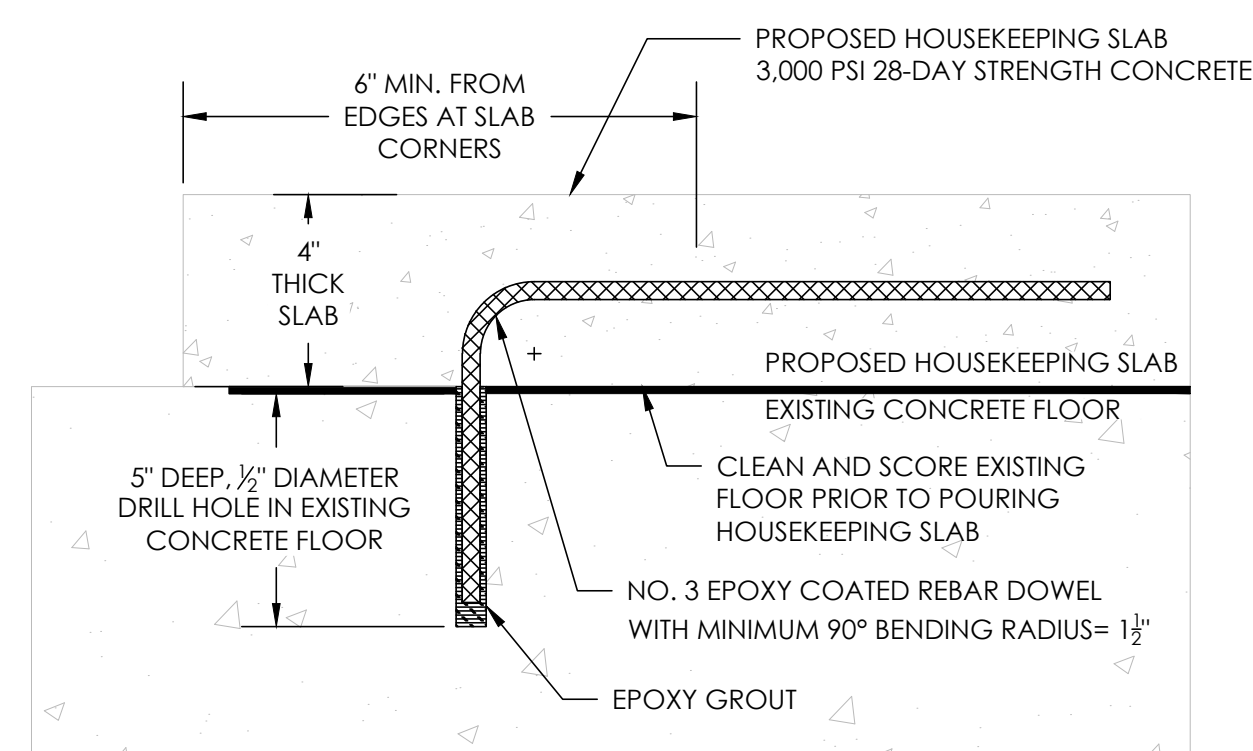

7 TYPICAL HOUSEKEEPING SLAB ELEVATION
C-203 NOT TO SCALE

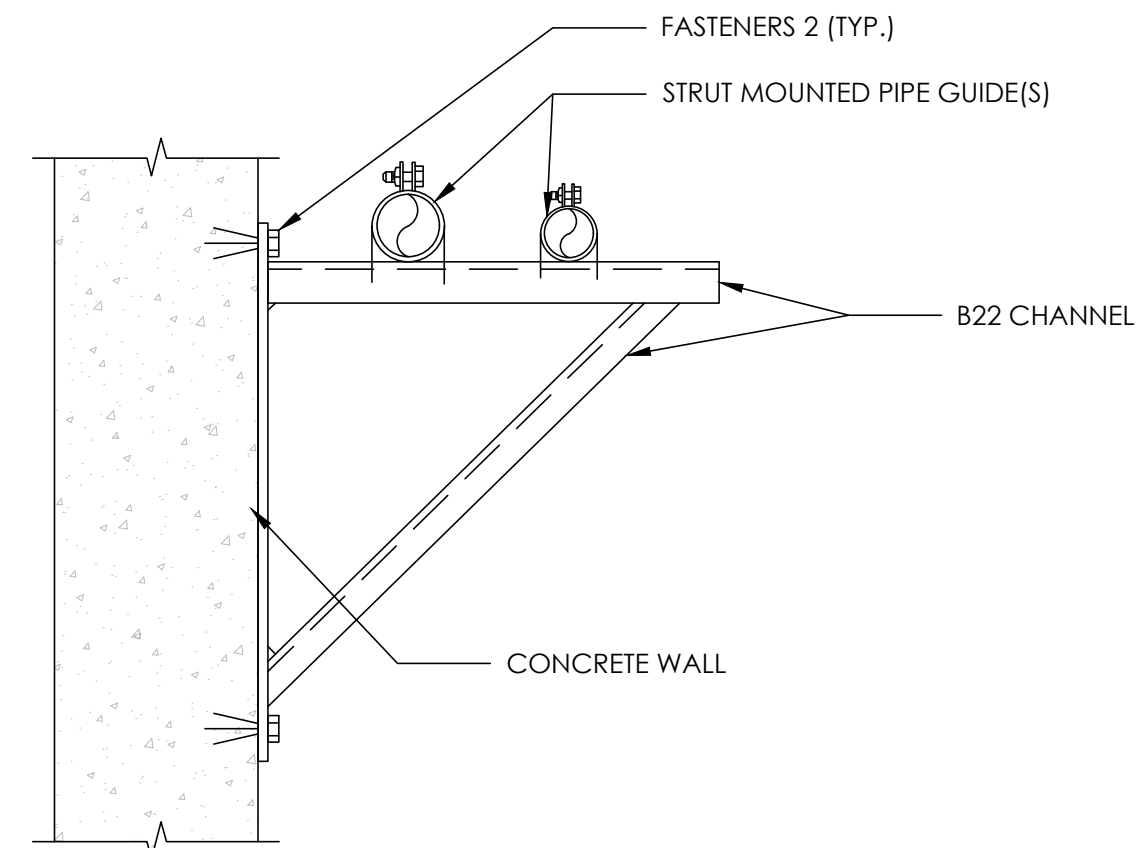

8 WALL MOUNTED PIPE SUPPORT
C-203 NOT TO SCALE

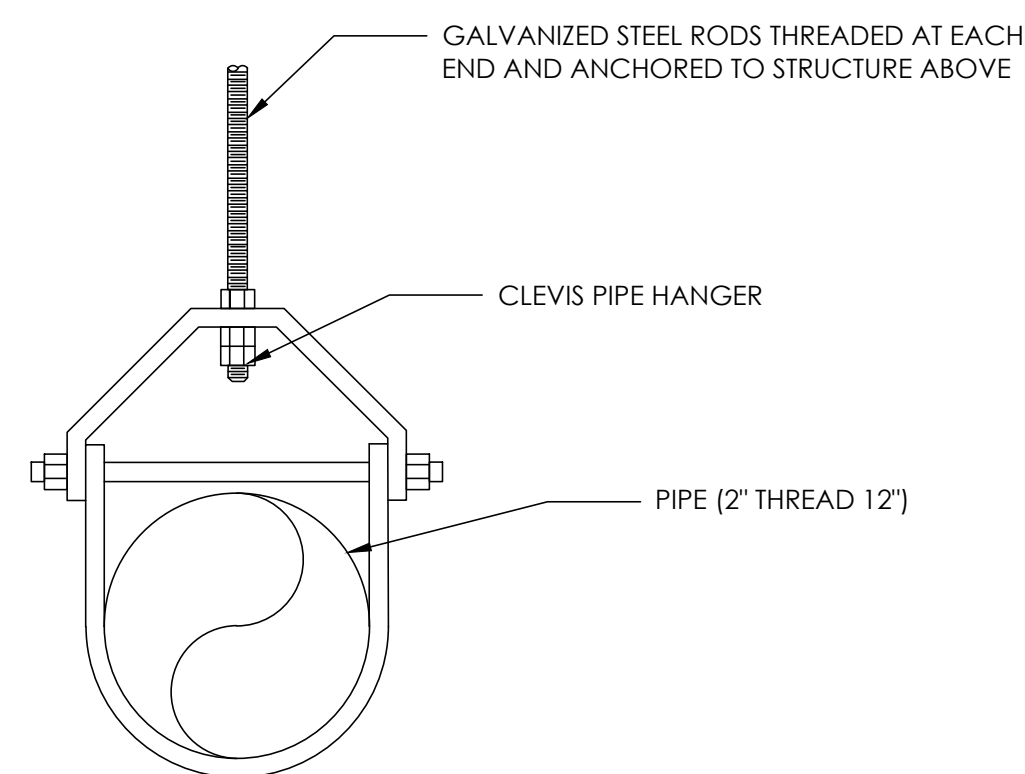

9 CLEVIS HANGER
C-203 NOT TO SCALE

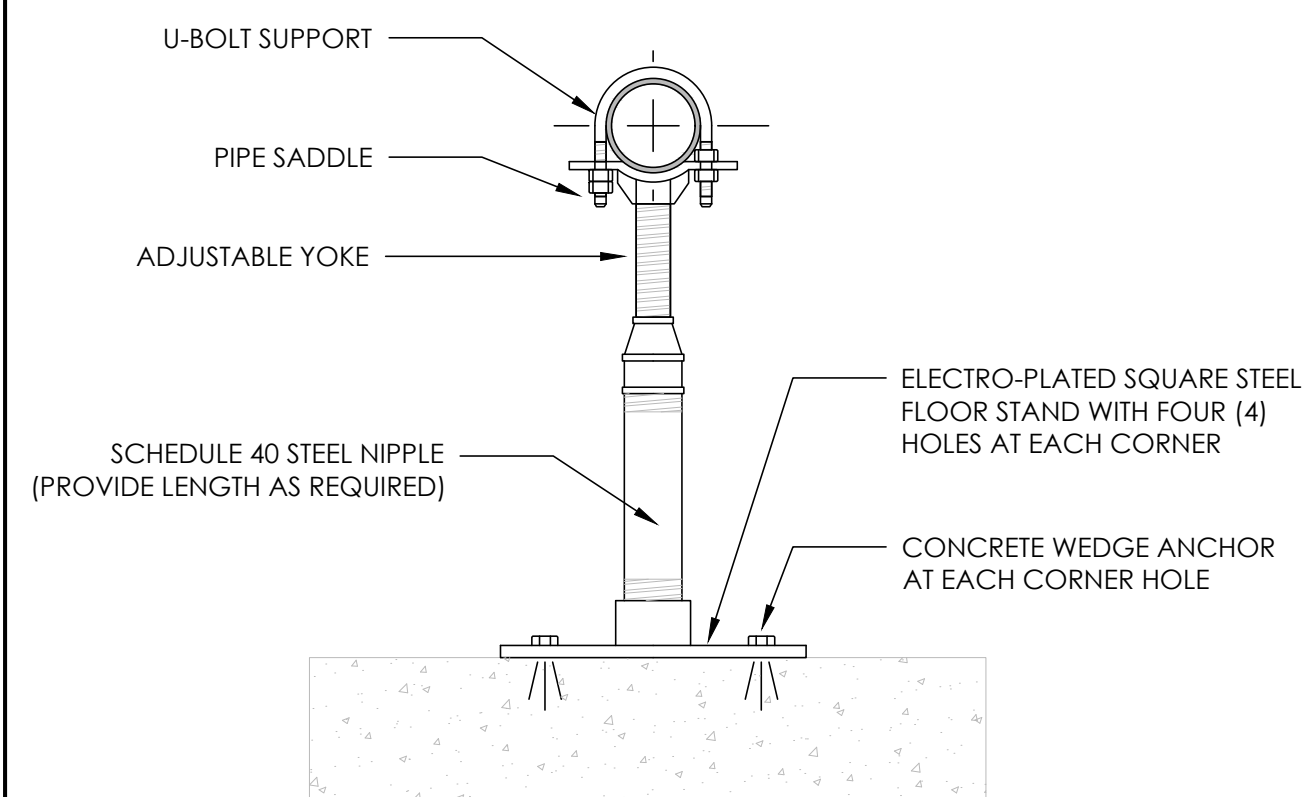

10 FLOOR MOUNTED PIPE SUPPORT
C-203 NOT TO SCALE

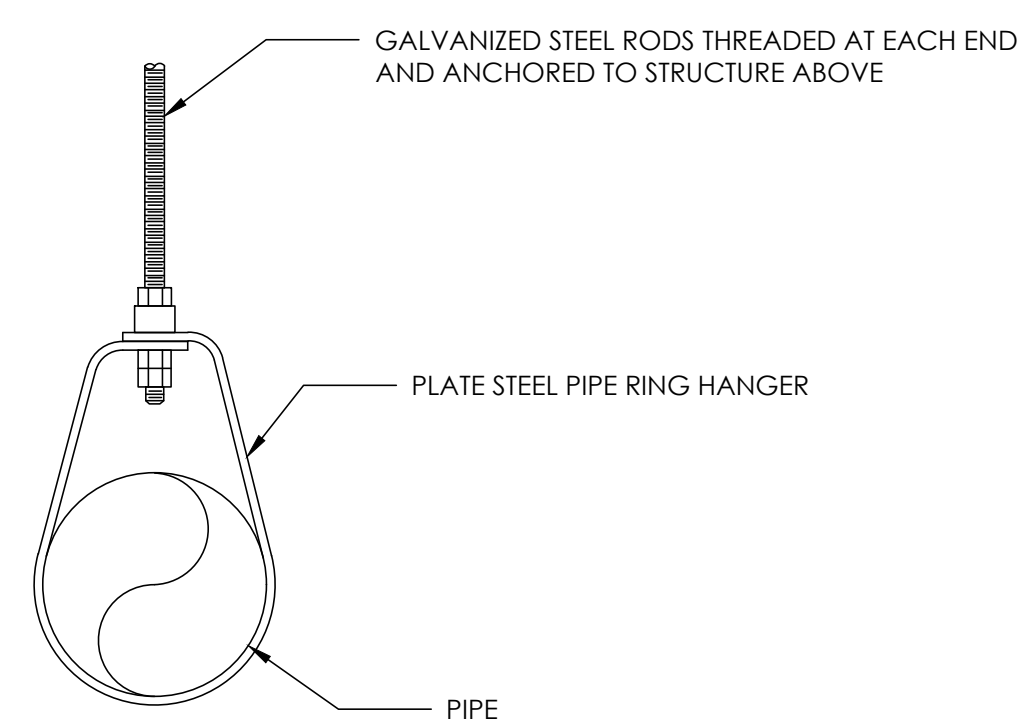

11 SWIVEL PIPE SUPPORT
C-203 NOT TO SCALE

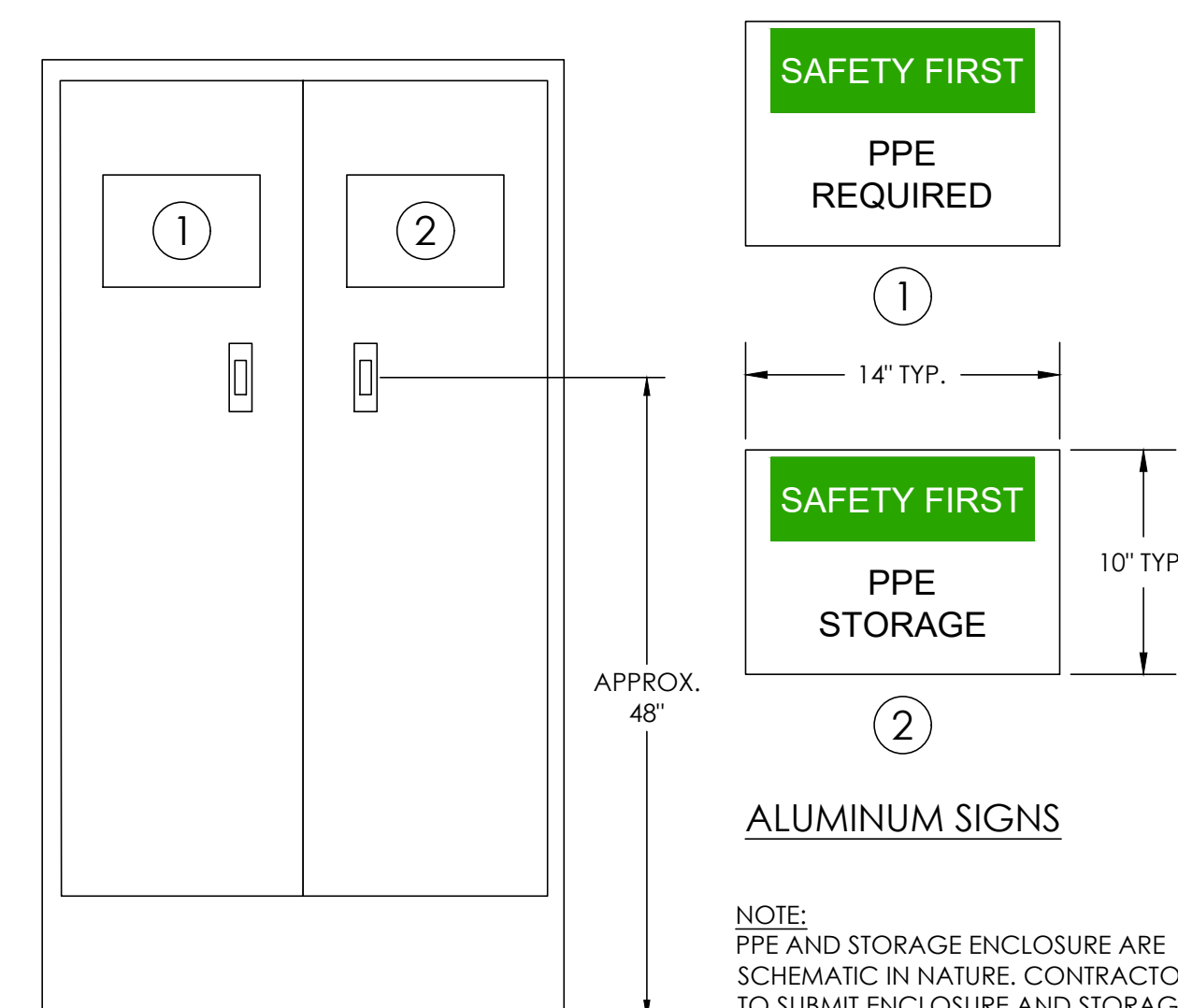

12 PPE AND STORAGE ENCLOSURE
C-203 NOT TO SCALE

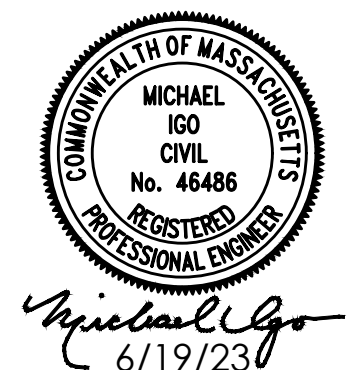

PERMITTING SET - NOT FOR CONSTRUCTION



CITY OF NEWBURYPORT
60 PLEASANT STREET
NEWBURYPORT, MA 01950

Rev No	Date	Drawn	Chkd	Description
REV 1	6/19/23	AEH	MI	DRAWING SET FOR NOTICE OF INTENT
REV 0	4/14/23	AEH	MI	DRAWING SET FOR NOTICE OF INTENT
Revisions				

Designed By:
A. Hammond
Checked By:
M. Igo
Date:
4-14-2023

SCALE: AS SHOWN

BARTLET MALL RESTORATION PROJECT

CIVIL DETAILS - 3

Sheet No.

C-203

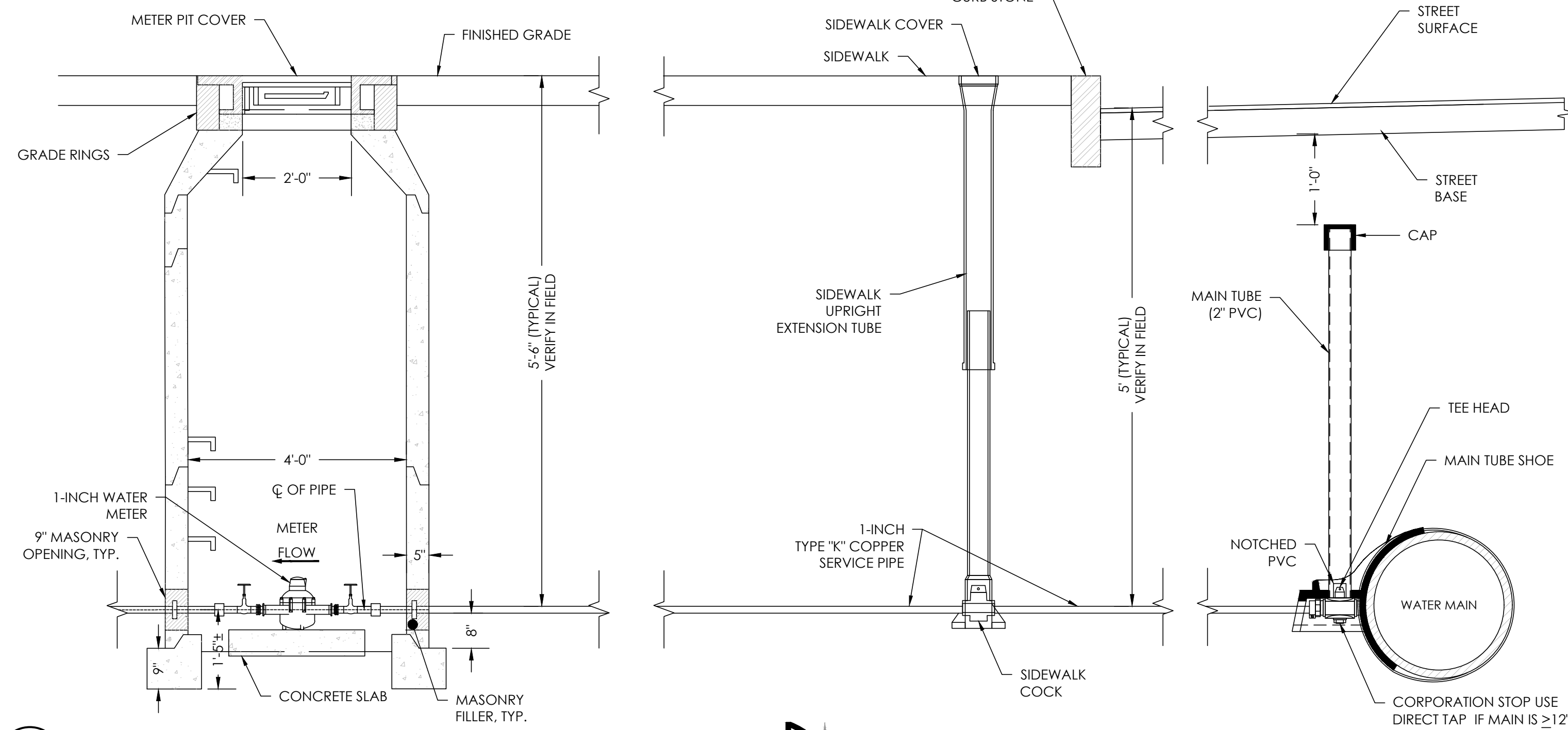

14 DOMESTIC WATER CONNECTION
C-204 NOT TO SCALE

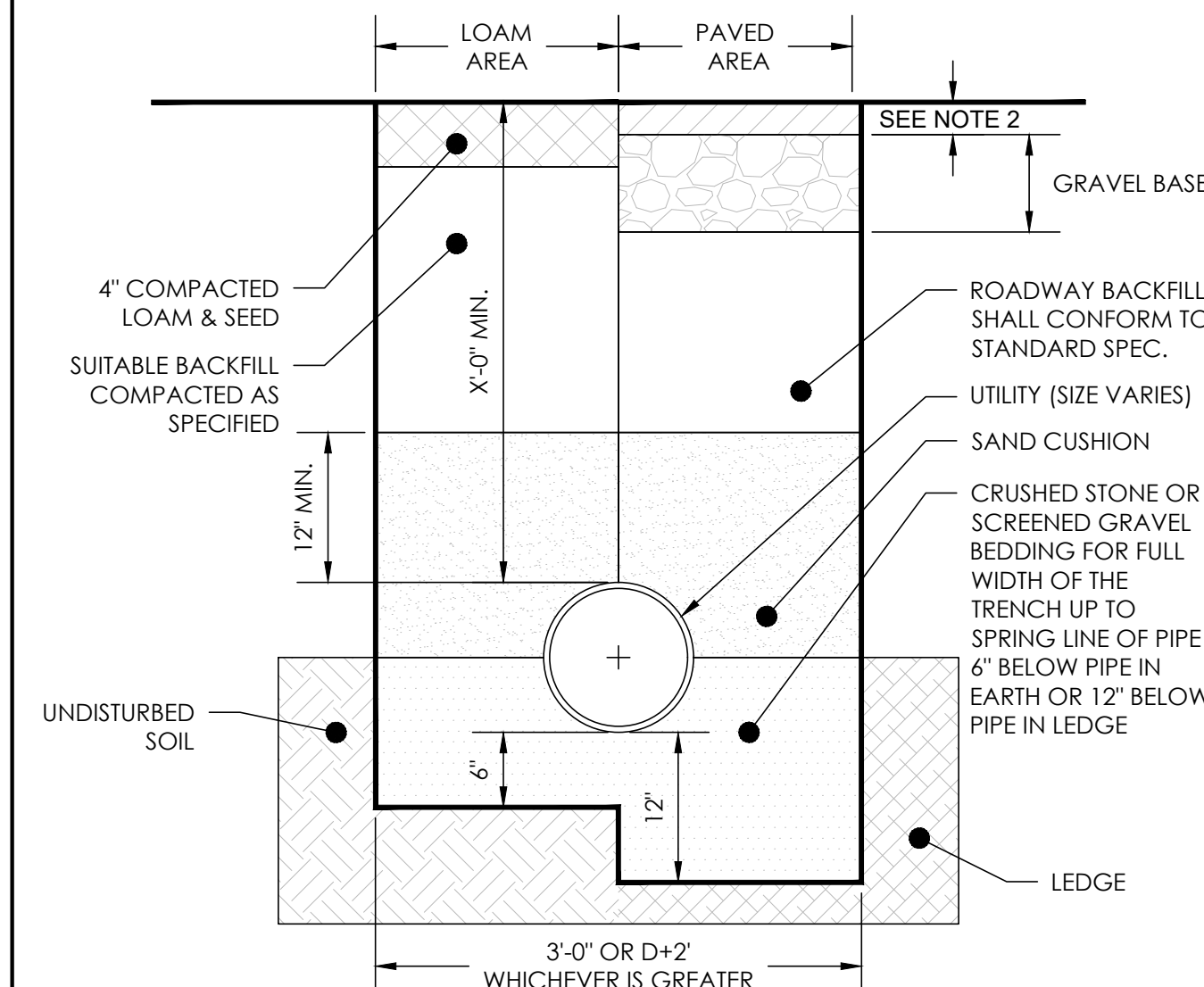

- NOTES:
1. ALL MATERIAL SHALL CONFORM TO CITY/TOWN OF DEPARTMENT OF PUBLIC WORKS.
 2. NEW ROADWAY CONSTRUCTION SHALL CONFORM TO CITY/TOWN SPECIFICATIONS.
 3. IN LIEU OF THE 12\"/>

17 UTILITY TRENCH DETAIL (NOT WITHIN POND LIMITS)
C-204 NOT TO SCALE

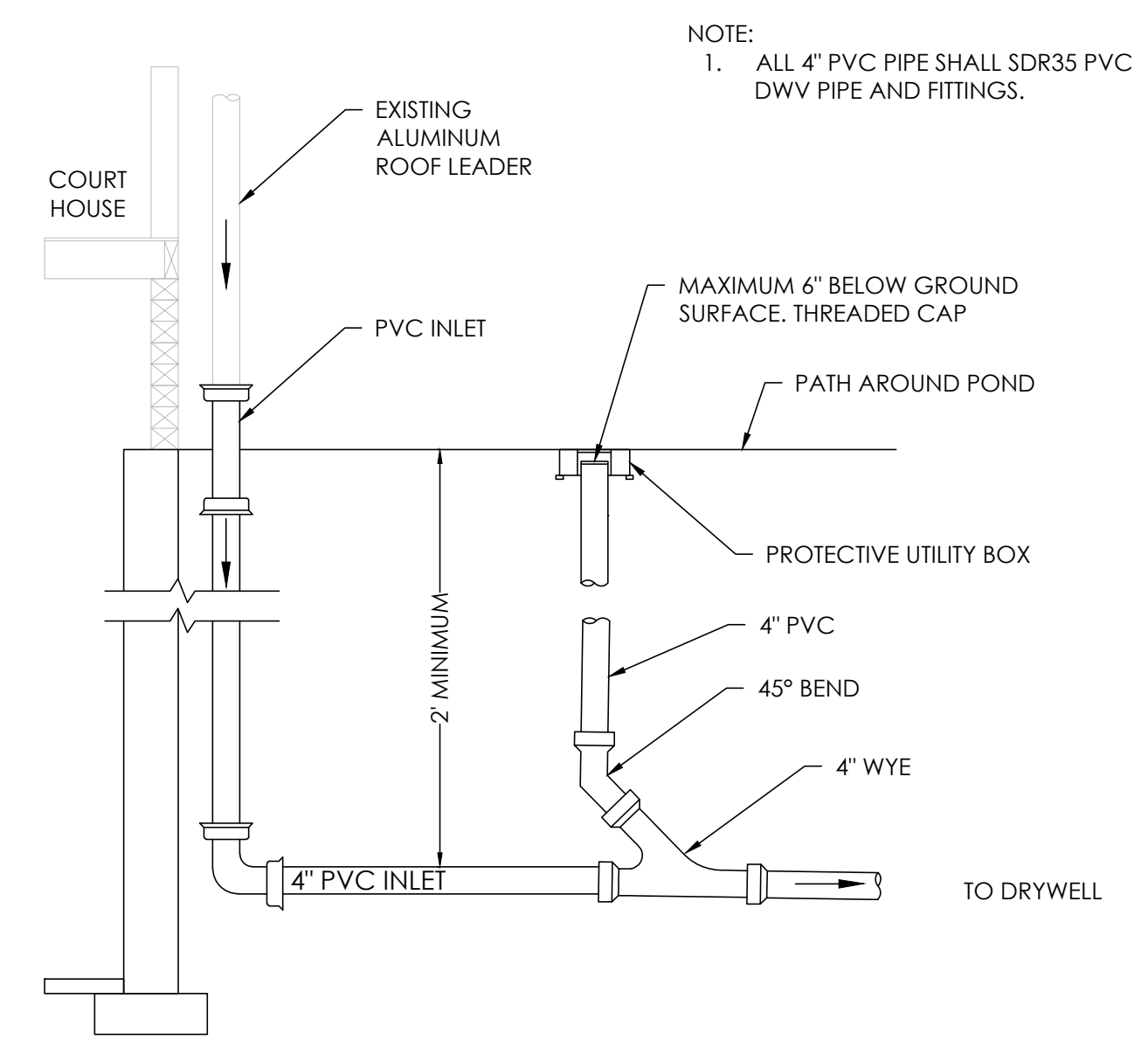

- NOTE:
1. ALL 4\"/>

16 ROOF LEADER TO DRYWELL
C-204 NOT TO SCALE



CITY OF NEWBURYPORT
60 PLEASANT STREET
NEWBURYPORT, MA 01950

Rev No	Date	Drawn	Chkd	Description
REV 1	6/19/23	AEH	MI	DRAWING SET FOR NOTICE OF INTENT
REV 0	4/14/23	AEH	MI	DRAWING SET FOR NOTICE OF INTENT
Revisions				

Designed By:
A. Hammond

Checked By:
M. Igo

Date:
4-14-2023

SCALE: AS SHOWN

BARTLET MALL RESTORATION PROJECT

CIVIL DETAILS - 4

Sheet No.
C-204

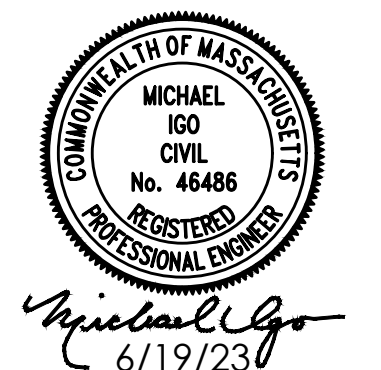

PERMITTING SET - NOT FOR CONSTRUCTION

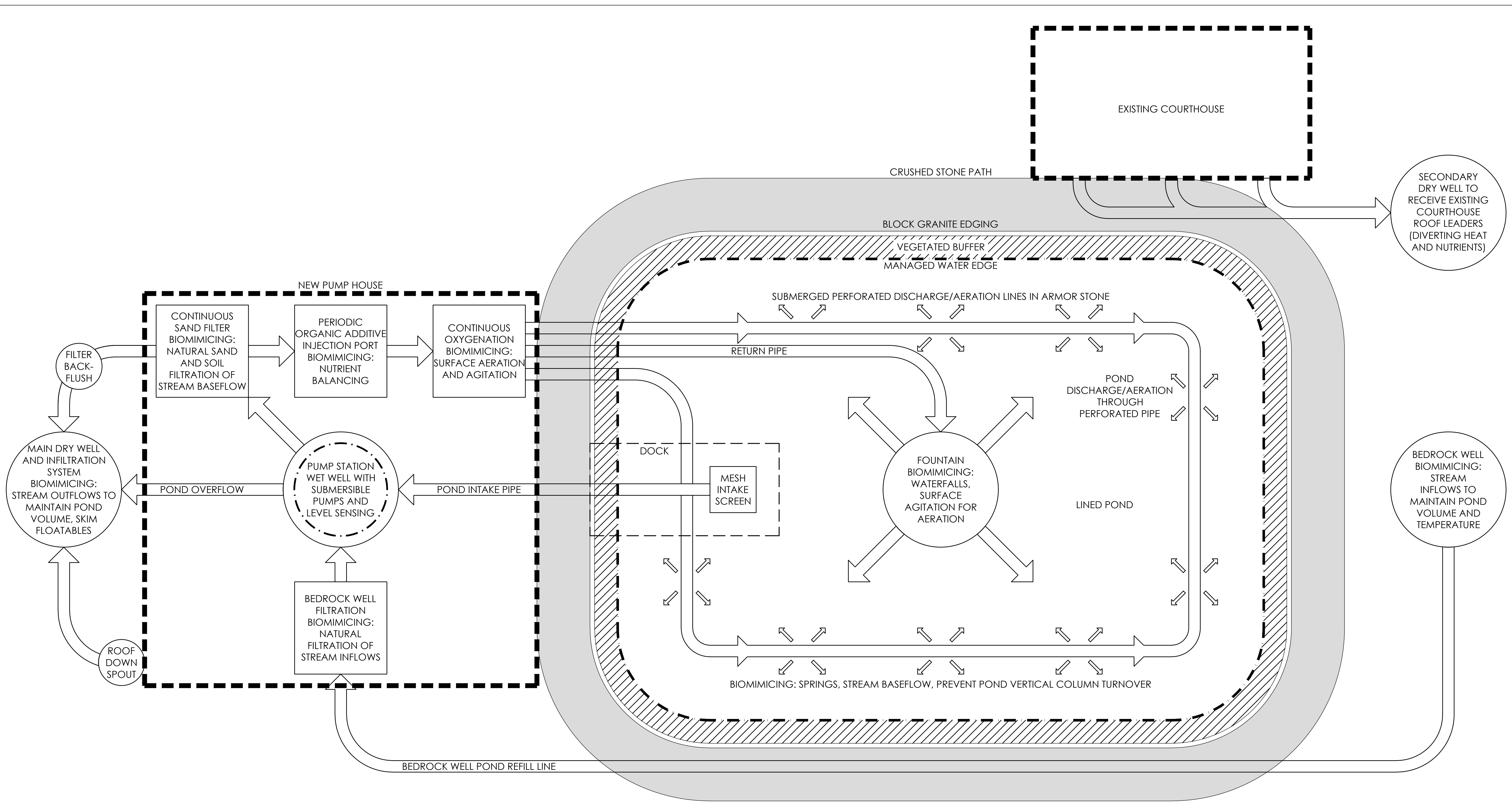
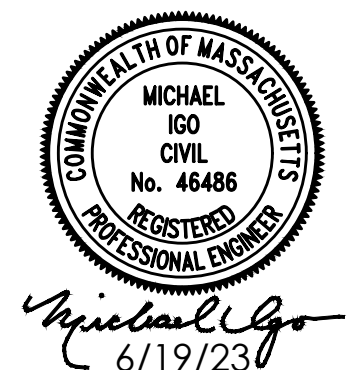

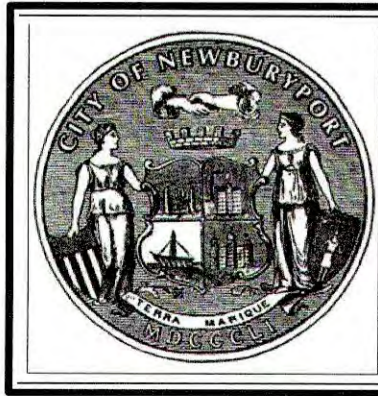

DIAGRAM NOT TO SCALE:
 PROVIDED TO DEMONSTRATE
 WATER FLOW PATHS FOR
 POND WATER QUALITY



PERMITTING SET - NOT FOR CONSTRUCTION

 <p>CITY OF NEWBURYPORT 60 PLEASANT STREET NEWBURYPORT, MA 01950</p>	<table border="1"> <tr> <td>REV 1</td> <td>6/19/23</td> <td>AEH</td> <td>MI</td> <td></td> </tr> <tr> <td>REV 0</td> <td>4/14/23</td> <td>AEH</td> <td>MI</td> <td></td> </tr> <tr> <td>Rev No</td> <td>Date</td> <td>Drawn</td> <td>Chkd</td> <td></td> </tr> </table>	REV 1	6/19/23	AEH	MI		REV 0	4/14/23	AEH	MI		Rev No	Date	Drawn	Chkd		<table border="1"> <tr> <td>Designed By:</td> <td>A. Hammond</td> </tr> <tr> <td>Checked By:</td> <td>M. Igo</td> </tr> <tr> <td>Date:</td> <td>4-14-2023</td> </tr> </table>	Designed By:	A. Hammond	Checked By:	M. Igo	Date:	4-14-2023	SCALE: NONE	BARTLET MALL RESTORATION PROJECT WATER QUALITY SYSTEM ONE LINE DIAGRAM	Sheet No. C-301
	REV 1	6/19/23	AEH	MI																						
	REV 0	4/14/23	AEH	MI																						
Rev No	Date	Drawn	Chkd																							
Designed By:	A. Hammond																									
Checked By:	M. Igo																									
Date:	4-14-2023																									
<table border="1"> <tr> <td></td> <td></td> <td></td> <td></td> <td></td> </tr> <tr> <td></td> <td></td> <td></td> <td></td> <td></td> </tr> <tr> <td></td> <td></td> <td></td> <td></td> <td></td> </tr> </table>																DRAWING SET FOR NOTICE OF INTENT DRAWING SET FOR NOTICE OF INTENT Description Revisions										



CITY OF NEWBURYPORT
 60 PLEASANT STREET
 NEWBURYPORT, MA 01950

Rev No	Date	Drawn	Chkd	Description
4	6/26/23	KT		ADA study & granite realignment & rotate pump house
3	3/22/23	KT		Relocated utility/storage shed & dock
2	1/18/23	KT		Revised ellipse
1	12/6/22	KT		Revised granite edge

Designed By:
 Kim Turner
 Checked By:
 [NAME]
 Date:
 12-01-2022

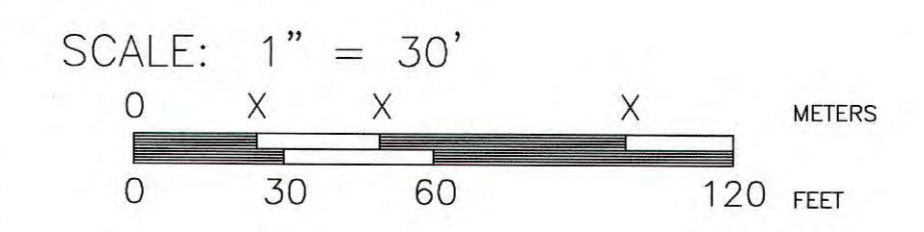

BARTLET MALL RESTORATION PROJECT
CONCEPTUAL SITE PLAN

Sheet No.
L-1