

RECEIVED  
CITY CLERK'S OFFICE  
NEWBURYPORT, MA

2022 MAR -2 PM 3: 08

## City of Newburyport

### Application Form **Restaurant License** **Occupy Outdoor City Property**

**\*\*DO NOT USE THIS APPLICATION FORM FOR EVENTS\*\***

Date Submitted: 03/02/2022

**Business Name:** MISSION OAK GRILL

**Business Contact:** WELLINGTON AUGUSTO

**Business Address:** 26 GREEN STREET **Phone:** 978-463-9009 **Email:** WAUGUSTO@MISSIONOAKGRILL.COM

**Property Owner:** NEWBURYPORT RESTAURANT ASSOCIATES, LLC

**Outdoor Tables** Quantity: 19 Dimensions: 24"W x 30"L x 30"H Material: Powder coated aluminum framing

**Outdoor Chairs** Quantity: 66 Dimensions: 19"W x 23"D x 33"H Material: Powder coated aluminum framing

**Proposed Days/Hours of Operation:** MO - TH 4PM - 9:30PM / FR & SA 4PM - 10PM  
SU 4PM - 9:30PM

#### Check all that apply:

- Applicant requests approval for food consumption.
- Applicant requests approval for alcohol consumption.
- Applicant requests approval for occupancy of public parking space(s).

#### Attach the following materials:

- 1) Evidence of liability insurance with minimum coverage in the amount of one million dollars (\$1,000,000) per occurrence, naming the City of Newburyport as co-insured, and in force for the entire approved period of occupancy.
- 2) A clear and legible 8½-inch x 11-inch diagram of the proposed area of occupancy, detailing:
  - a) Perimeter of proposed areas of occupancy, with relevant linear dimensions;
  - b) Public, pedestrian path of travel no less than five feet in width;
  - c) All relevant obstacles such as streetlights, signs, trees, etc.; and
  - d) All tables, chairs, seats, total seating count and total occupancy; and
  - e) Means to demarcate any areas proposed for the service of food and alcohol.
- 3) Written authorization signed by the Applicant's landlord acknowledging and agreeing to the use of the adjacent portion of any public way.

**Applications shall be delivered to the Office of the City Clerk by hand, mail, or email:**

- 1) Office of the City Clerk  
Newburyport City Hall  
60 Pleasant Street  
Newburyport, MA 01950  
(978) 465-4407 ext. 1205  
[rjones@cityofnewburport.com](mailto:rjones@cityofnewburport.com)
- 2) The deadline for applications is the close of business 7:00 pm Thursday, March 10<sup>th</sup>.

**Processing:**

- 1) Application fee \$100.00  
Occupancy fee \$5/sq. ft. pending in City Council.
- 2) Applications will be reviewed by the City Council and forwarded to the Licensing Board. For applications to occupy a city park or playground, the City Council shall not consider or act upon such application until the earlier of (i) having received a recommendation by the Parks Commission regarding such application, or (ii) 30 days from the City Clerk's receipt of such complete application.
- 3) The **Licensing Board will then conduct a public hearing** on each application and determine whether to approve, approve conditionally, or deny it. The Licensing Board may not approve an application without a favorable recommendation by the City Council.
- 4) The City has no obligation whatsoever to approve any individual application, each of which shall be processed, reviewed, and a determination thereon made by the relevant City officers, boards, and commissions in their reasonable discretion.
- 5) Any condition of approval and submitted plan shall be in force for the entire duration of any validly issued license.
- 6) Any license issued may be revoked at any time by super-majority vote of the City Council, after a public hearing, for any reason, or no reason.

**RELEASE AND INDEMNITY AGREEMENT TO ENCUMBER A PUBLIC WAY**

I, the undersigned Applicant or Duly Authorized Agent, hereby agree to RELEASE, DISCHARGE, and HOLD HARMLESS, the City of Newburyport, a municipal corporation of the Commonwealth of Massachusetts, and its officers, employees, agents, and servants from all actions, causes of action, claims, demands, damages, costs, loss of services, expenses and compensation associated with the undersigned's use of the public way or other city property as described herein.

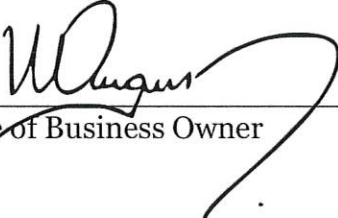
  
\_\_\_\_\_  
Signature of Business Owner

03/02/2022  
\_\_\_\_\_  
DATE

## **City of Newburyport**

### **Outdoor Tables & Chairs**

- 1) A minimum of five-feet of pedestrian clearance must be maintained for public pedestrian access. Tables, chairs, and/or all enclosure materials used to create a demarcated area for serving alcohol may not impede this required pedestrian clearance.
- 2) Tables, chairs, and/or enclosure materials to create a demarcated area for serving alcohol must maintain a minimum of 5-feet of pedestrian clearance from streetlights, signs, trees, benches, garbage barrels, or other sidewalk obstacles.
- 3) Tables, chairs, and/or personal property used to demarcate an area cannot interfere with curb ramps, driveways, fire escapes and/or doorways.
- 4) All tables and chairs that are chained, roped, or otherwise tethered together after business hours must be untethered during business hours.
- 5) Placement of tables and chairs on city property must conform in all respects to all applicable federal, state, and local laws and regulations, including, without limitation workplace safety rules and other public health regulations. **Please contact the Newburyport Health Department for workplace safety rules specific to your business sector.**
- 6) Like any license, permission to place tables and chairs outdoors on city property is revocable at the discretion of the City of Newburyport.
- 7) Initial licenses, unless revoked, shall remain effective until on or about October 31<sup>st</sup> and commencing on or about May 1<sup>st</sup>.

N.B. ODNC098\_10\_12\_2021 is pending in City Council and may amend requirements to this license.



HANDICAP RAMP - PLEASANT STREET

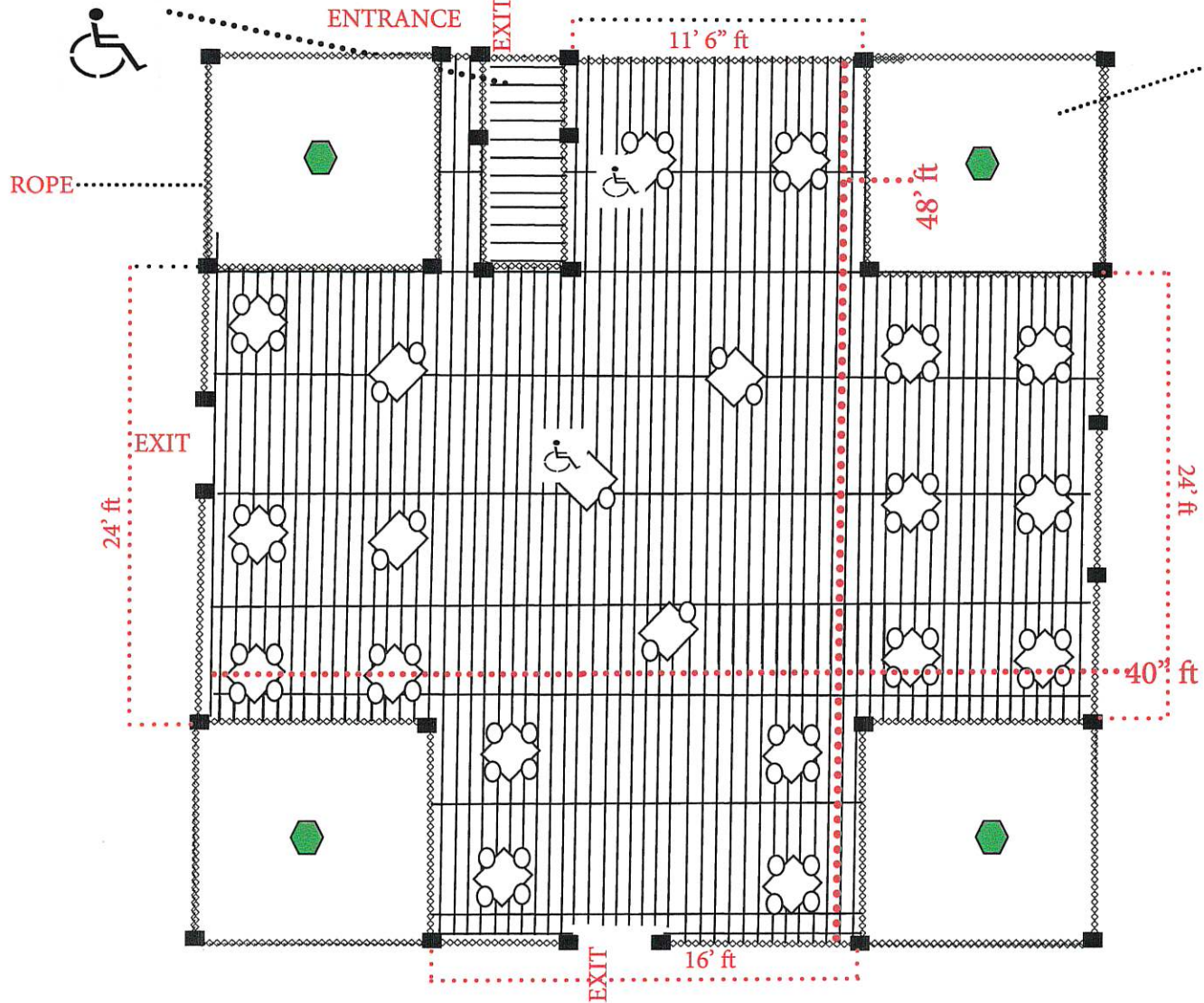

TREES  
*All good ADA*

- 19 Tables Total
- 14 Tables 4 chairs
- 5 Tables 2 chairs
- Total Chairs = 66

BROWN SQUARE WOOD PATIO