

FORM B - BUILDING

NRDIS 8/2/1984

Assessor's number
1-19USGS Quad
NewburyportArea(s)
L,UForm Number
2963

Massachusetts Historical Commission
 Massachusetts Archives Building
 220 Morrissey Boulevard
 Boston, Massachusetts 02125

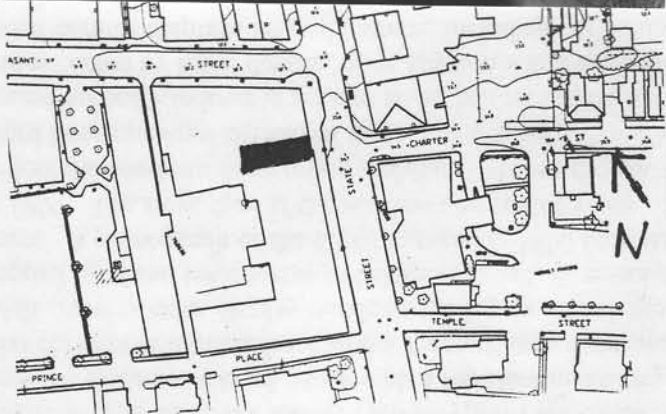

Town Newburyport

Place (neighborhood or village)

Address 70 State Street

Historic Name George Plumer Building

Uses: Present Commercial

Original Commercial

Date of Construction 1876

Source Herald, 5/17/1876

Style/Form Italianate

Architect/Builder unknown

Exterior Material:

Foundation Granite

Wall/Trim Brick/Sandstone

Roof Tar

Outbuildings/Secondary Structures

none

Major Alterations (with dates) c.1900 - second floor
 bay window; c.1970 - storefront alteration

Condition good

Moved ☒ no ☐ yes Date

Acreage 2790 SF

Setting central business district, adjacent to former
 Newburyport Five Cents Savings Bank

Recorded by Lisa Mausolf

Organization Newburyport Historical Commission

Date (month/year) May 1999

BUILDING FORM (70 State Street)

ARCHITECTURAL DESCRIPTION

Describe architectural features. Evaluate the characteristics of the building in terms of other buildings within the community.

Located adjacent to the former Newburyport Five Cents Savings Bank (MHC#362), the building at 70 State Street is a narrow, three-story brick block with a top floor measuring just four bays wide. The first floor storefront was altered c.1970 and consists of a brick front with a recessed center entrance containing a glass-and-wood door. The entrance is flanked by multi-light wooden display windows resting on a brick base. The storefront is capped by a three-part cornice with dentils, topped by about ten courses of brick. A broad, three-sided bay window occupies the entire second floor, flanked by brick piers. A photograph of the building taken in 1890 indicates that this window is a later addition, and it probably dates to c.1900. The front face of the window consists of a pair of windows with larger windows on either side. The wooden panels below the windows have raised moldings. Above the bay window is a projecting cornice supported by two end brackets. The third floor openings consist of three replacement 2/2 windows with a more slender 1/1 window to the north. Each of the round-arched windows is set into an arched recess, with a sandstone sill and flanked by brick piers. The window openings are accented by brick dentils, stone keystones and springblocks painted white. Above the openings the multi-tiered decorative brick cornice displays several patterns including corbelling. The projecting cornice above is supported by a pair of end brackets.

According to an article appearing in the Daily News in 1890, the building was enlarged in 1887 and at the time of the article the owner intended to again enlarge it, thus making it more than double the size of the original structure.

HISTORICAL NARRATIVE

Describe the history of the building. Explain its associations with local (or state) history. Include uses of the building and the role(s) the owners/occupants played within the community.

This building was constructed soon after the adjacent Newburyport Five Cents Savings Bank building (MHC#362) was erected in 1873. It was built for George H. Plumer in 1876, to house his dry goods store (Herald, 5/17/1876). Plumer was born in Newburyport in 1847 and graduated from the Putnam School in 1864. After his schooling, he entered the store of his father (Richard Plumer) and remained with him until 1872 when he began his own business at 46 State Street (MHC#2208). George Plumer continued to operate a dry goods store at 70 State Street until about 1920.

The J.J. Newberry 5 & 10 cents store occupied the building from about 1940 until the 1960s.

BIBLIOGRAPHY and/or REFERENCES

- Currier, John J. *History of Newburyport, Massachusetts, 1764-1906*, vols. 1 & 2. Newburyport: 1906 & 1909.
Irving, Ron. Unpublished research on State Street.
Massachusetts Historical Commission. Historic Resources Inventory: Newburyport.
Newburyport City Directories, various dates.
Newburyport Herald, May 17, 1876.
Sanborn Insurance Maps. Massachusetts State Library, Boston, Massachusetts.
"Some Prominent Mercantile Establishments: George H. Plumer", Newburyport Daily News, October 11, 1890.

Recommended for listing in the National Register of Historic Places. *If checked, you must attached a completed National Register Criteria Statement form.*