

# Massachusetts Cultural Resource Information System

## Scanned Record Cover Page

<b>Inventory No:</b>	NWB.589
<b>Historic Name:</b>	
<b>Common Name:</b>	
<b>Address:</b>	69 High St
<b>City/Town:</b>	Newburyport
<b>Village/Neighborhood:</b>	
<b>Local No:</b>	200; 33-29; 38-75
<b>Year Constructed:</b>	C 1800
<b>Architect(s):</b>	
<b>Architectural Style(s):</b>	Federal
<b>Use(s):</b>	Single Family Dwelling House
<b>Significance:</b>	Architecture
<b>Area(s):</b>	NWB.A: High Street District NWB.L: Newburyport Historic District
<b>Designation(s):</b>	Nat'l Register District (8/2/1984)



The Massachusetts Historical Commission (MHC) has converted this paper record to digital format as part of ongoing projects to scan records of the Inventory of Historic Assets of the Commonwealth and National Register of Historic Places nominations for Massachusetts. Efforts are ongoing and not all inventory or National Register records related to this resource may be available in digital format at this time.

The MACRIS database and scanned files are highly dynamic; new information is added daily and both database records and related scanned files may be updated as new information is incorporated into MHC files. Users should note that there may be a considerable lag time between the receipt of new or updated records by MHC and the appearance of related information in MACRIS. Users should also note that not all source materials for the MACRIS database are made available as scanned images. Users may consult the records, files and maps available in MHC's public research area at its offices at the State Archives Building, 220 Morrissey Boulevard, Boston, open M-F, 9-5.

Users of this digital material acknowledge that they have read and understood the MACRIS Information and Disclaimer (<http://mhc-macris.net/macrisdisclaimer.htm>)

Data available via the MACRIS web interface, and associated scanned files are for information purposes only. THE ACT OF CHECKING THIS DATABASE AND ASSOCIATED SCANNED FILES DOES NOT SUBSTITUTE FOR COMPLIANCE WITH APPLICABLE LOCAL, STATE OR FEDERAL LAWS AND REGULATIONS. IF YOU ARE REPRESENTING A DEVELOPER AND/OR A PROPOSED PROJECT THAT WILL REQUIRE A PERMIT, LICENSE OR FUNDING FROM ANY STATE OR FEDERAL AGENCY YOU MUST SUBMIT A PROJECT NOTIFICATION FORM TO MHC FOR MHC'S REVIEW AND COMMENT. You can obtain a copy of a PNF through the MHC web site ([www.sec.state.ma.us/mhc](http://www.sec.state.ma.us/mhc)) under the subject heading "MHC Forms."

Commonwealth of Massachusetts  
Massachusetts Historical Commission  
220 Morrissey Boulevard, Boston, Massachusetts 02125  
[www.sec.state.ma.us/mhc](http://www.sec.state.ma.us/mhc)

This file was accessed on:

Friday, April 18, 2014 at 12:34 PM



Art/sculpture  
Education  
Government  
Literature  
Music

Travel/communication  
Military affairs  
Religion/philosophy  
Indians  
Development of town/city

2. Town Newburyport Mass  
Street address 69 High St  
Name \_\_\_\_\_  
Original use Res  
Present use Res  
Present owner Ethel Otto  
Open to public no  
Date 12- Style Federal  
Source of date \_\_\_\_\_  
Architect \_\_\_\_\_

3. CONDITION: Excellent Good Fair Deteriorated Moved Altered Added \_\_\_\_\_

#### 4. DESCRIPTION

FOUNDATION/BASEMENT: High Regular Low Material: Granite

WALL COVER: Wood Panel-Horiz-Board Brick Stone Other \_\_\_\_\_

ROOF: Ridge Gambrel Flat Hip Mansard  
Tower Cupola Dormer windows Balustrade Grillwork

CHIMNEYS: 1 2 3 4 Center End Interior Irregular Cluster Elaborate

STORIES: 1 2 3 4 ATTACHMENTS: Wings Ell Shed \_\_\_\_\_

PORCHES: 1 2 3 4 PORTICO Balcony

FACADE: Gable end: Front/Side Ornament: Porch Balustrade

Entrance: Side Front Center Side Details: \_\_\_\_\_

Windows: Spacing: Regular Irregular Identical/Varied \_\_\_\_\_

Corners: Plain Pilasters Quoins Cornerboards \_\_\_\_\_

5. Indicate location of structure in relation to nearest cross streets and other buildings  
6. Footage of structure from street 150  
Property has 150 feet frontage on street

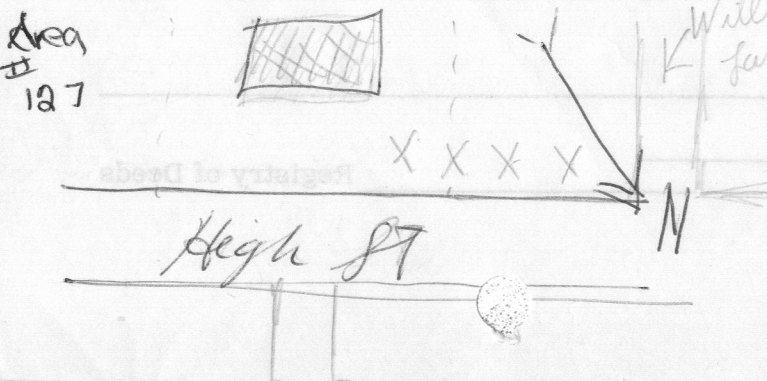

Recorder Wall  
For Historical Comm  
Photo ✓ Date 1969

SEE REVERSE SIDE

MAP M  
III

RELATION OF SURROUNDING TO STRUCTURE

NWB.589

1. Outbuildings \_\_\_\_\_

2. Landscape Features: Agriculture Open Wooded Garden Formal Informal

Predominant features \_\_\_\_\_

Landscape architect \_\_\_\_\_

3. Neighboring Structures

Style: Colonial Federal Greek Revival Gothic Revival Italian Villa Lombard Rom.  
Venetian Gothic Mansard Richardsonian Modern

Use: Residential Commercial Religious Conditions: Excellent Good Fair Deteriorated

GIVE A BRIEF DESCRIPTION OF HISTORIC IMPORTANCE OF SITE (Refer and elaborate on theme circled on front of form)

BIBLIOGRAPHY AND/OR REFERENCE

RESTRICTIONS \_\_\_\_\_

Original Owner: \_\_\_\_\_

Deed Information: Book Number \_\_\_\_\_ Page \_\_\_\_\_, Registry of Deeds