

Massachusetts Cultural Resource Information System

Scanned Record Cover Page

Inventory No:	NWB.659
Historic Name:	
Common Name:	
Address:	64 Federal St
City/Town:	Newburyport
Village/Neighborhood:	
Local No:	530; 15-66
Year Constructed:	C 1775
Architect(s):	
Architectural Style(s):	Georgian
Use(s):	Multiple Family Dwelling House; Single Family Dwelling House
Significance:	Architecture
Area(s):	NWB.D: South End District NWB.L: Newburyport Historic District
Designation(s):	Nat'l Register District (8/2/1984)



The Massachusetts Historical Commission (MHC) has converted this paper record to digital format as part of ongoing projects to scan records of the Inventory of Historic Assets of the Commonwealth and National Register of Historic Places nominations for Massachusetts. Efforts are ongoing and not all inventory or National Register records related to this resource may be available in digital format at this time.

The MACRIS database and scanned files are highly dynamic; new information is added daily and both database records and related scanned files may be updated as new information is incorporated into MHC files. Users should note that there may be a considerable lag time between the receipt of new or updated records by MHC and the appearance of related information in MACRIS. Users should also note that not all source materials for the MACRIS database are made available as scanned images. Users may consult the records, files and maps available in MHC's public research area at its offices at the State Archives Building, 220 Morrissey Boulevard, Boston, open M-F, 9-5.

Users of this digital material acknowledge that they have read and understood the MACRIS Information and Disclaimer (<http://mhc-macris.net/macrisdisclaimer.htm>)

Data available via the MACRIS web interface, and associated scanned files are for information purposes only. THE ACT OF CHECKING THIS DATABASE AND ASSOCIATED SCANNED FILES DOES NOT SUBSTITUTE FOR COMPLIANCE WITH APPLICABLE LOCAL, STATE OR FEDERAL LAWS AND REGULATIONS. IF YOU ARE REPRESENTING A DEVELOPER AND/OR A PROPOSED PROJECT THAT WILL REQUIRE A PERMIT, LICENSE OR FUNDING FROM ANY STATE OR FEDERAL AGENCY YOU MUST SUBMIT A PROJECT NOTIFICATION FORM TO MHC FOR MHC'S REVIEW AND COMMENT. You can obtain a copy of a PNF through the MHC web site (www.sec.state.ma.us/mhc) under the subject heading "MHC Forms."

Commonwealth of Massachusetts
Massachusetts Historical Commission
220 Morrissey Boulevard, Boston, Massachusetts 02125
www.sec.state.ma.us/mhc

This file was accessed on:

Friday, April 18, 2014 at 11:41 AM

NWB.659

Area D+1

659



	BB	530
--	----	-----

2. Town Newburyport MassStreet address 53 Temple StName also 64 Federal StOriginal use ResPresent use " 2 FamilyPresent owner John A LagueOpen to public NoDate _____ Style Colonial

Source of date _____

Architect _____

Education

Military affairs

Government

Religion/philosophy

Literature

Indians

Music

Development of town/city

3. CONDITION: Excellent Good Fair Deteriorated Moved Altered Added

4. DESCRIPTION

FOUNDATION/BASEMENT: High Regular Low Material: BrickWALL COVER: Wood Clapboard Brick Stone Other _____ROOF: Ridge Gambrel Flat Hip Mansard
Tower Cupola Dormer windows Balustrade Grillwork _____CHIMNEYS: 1 2 3 4 Center End Interior Irregular Cluster ElaborateSTORIES: 1 2 3 4 ATTACHMENTS: Wings Ell Shed _____

PORCHES: 1 2 3 4 _____ PORTICO _____ Balcony _____

FACADE: Gable end: Front/Side Ornament: _____

Entrance: Side Front Center/Side Details: 2 FamilyWindows: Spacing: Regular Irregular Identical/Varied _____Corners: Plain Pilasters Quoins Cornerboards

5. Indicate location of structure in relation to nearest cross streets and other buildings

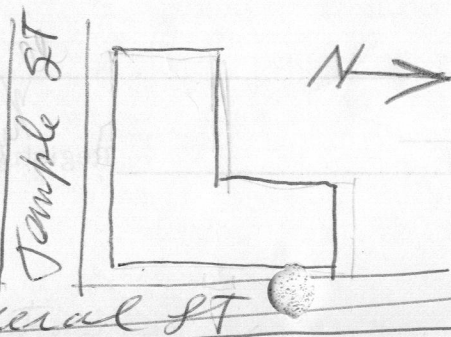
6. Footage of structure from street 6 ft
Property has 50 feet frontage on streetRecorder HallFor Historical CommPhoto ✓Date 1969

SEE REVERSE SIDE

JUN 29 1973

RELATION OF SURROUNDING TO STRUCTURE

NWB.659

1. Outbuildings

2. Landscape Features: Agriculture Open Wooded Garden: Formal/Informal

Predominant features

Landscape architect

3. Neighboring Structures

Style: Colonial Federal Greek Revival Gothic Revival Italian Villa Lombard Rom.

Venetian Gothic Mansard Richardsonian Modern

Use: Residential Commercial Religious

Conditions: Excellent Good Fair Deteriorated

GIVE A BRIEF DESCRIPTION OF HISTORIC IMPORTANCE OF SITE (Refer and elaborate on theme circled on front of form)

2 main entrances one at 53 Temple
and one at 64 Federal St

Both bldgs Gambrel roofed

BIBLIOGRAPHY AND/OR REFERENCE

RESTRICTIONS

Original Owner:

Deed Information: Book Number Page , Registry of Deeds