

# Massachusetts Cultural Resource Information System

## Scanned Record Cover Page

<b>Inventory No:</b>	NWB.650
<b>Historic Name:</b>	
<b>Common Name:</b>	
<b>Address:</b>	51 Middle St
<b>City/Town:</b>	Newburyport
<b>Village/Neighborhood:</b>	
<b>Local No:</b>	422; 16-41
<b>Year Constructed:</b>	C 1780
<b>Architect(s):</b>	
<b>Architectural Style(s):</b>	Federal
<b>Use(s):</b>	Single Family Dwelling House
<b>Significance:</b>	Architecture
<b>Area(s):</b>	NWB.D: South End District NWB.L: Newburyport Historic District
<b>Designation(s):</b>	Nat'l Register District (8/2/1984)



The Massachusetts Historical Commission (MHC) has converted this paper record to digital format as part of ongoing projects to scan records of the Inventory of Historic Assets of the Commonwealth and National Register of Historic Places nominations for Massachusetts. Efforts are ongoing and not all inventory or National Register records related to this resource may be available in digital format at this time.

The MACRIS database and scanned files are highly dynamic; new information is added daily and both database records and related scanned files may be updated as new information is incorporated into MHC files. Users should note that there may be a considerable lag time between the receipt of new or updated records by MHC and the appearance of related information in MACRIS. Users should also note that not all source materials for the MACRIS database are made available as scanned images. Users may consult the records, files and maps available in MHC's public research area at its offices at the State Archives Building, 220 Morrissey Boulevard, Boston, open M-F, 9-5.

Users of this digital material acknowledge that they have read and understood the MACRIS Information and Disclaimer (<http://mhc-macris.net/macrisdisclaimer.htm>)

Data available via the MACRIS web interface, and associated scanned files are for information purposes only. THE ACT OF CHECKING THIS DATABASE AND ASSOCIATED SCANNED FILES DOES NOT SUBSTITUTE FOR COMPLIANCE WITH APPLICABLE LOCAL, STATE OR FEDERAL LAWS AND REGULATIONS. IF YOU ARE REPRESENTING A DEVELOPER AND/OR A PROPOSED PROJECT THAT WILL REQUIRE A PERMIT, LICENSE OR FUNDING FROM ANY STATE OR FEDERAL AGENCY YOU MUST SUBMIT A PROJECT NOTIFICATION FORM TO MHC FOR MHC'S REVIEW AND COMMENT. You can obtain a copy of a PNF through the MHC web site ([www.sec.state.ma.us/mhc](http://www.sec.state.ma.us/mhc)) under the subject heading "MHC Forms."

Commonwealth of Massachusetts  
Massachusetts Historical Commission  
220 Morrissey Boulevard, Boston, Massachusetts 02125  
[www.sec.state.ma.us/mhc](http://www.sec.state.ma.us/mhc)

This file was accessed on:

Tuesday, April 22, 2014 at 12:15 PM

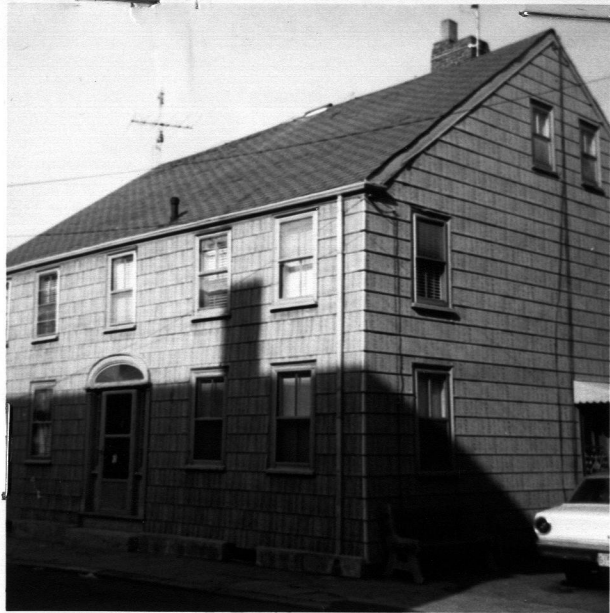

NWB.650 area D+L (650)

	X	(422)
--	---	-------

SSION  
oston2. Town NewburyportStreet address 51 Middle Stant to:  
on

Name \_\_\_\_\_

ith the  
de):Original use ResidencePresent use "Present owner Michael Rymba

ry

Open to public NoDate 1780 Style GloriousSource of date Owner

Architect \_\_\_\_\_

Education

Government

Literature

Music

Military affairs

Religion/philosophy

Indians

Development of town/city

3. CONDITION: Excellent Good Fair Deteriorated Moved Altered Added \_\_\_\_\_

## 4. DESCRIPTION

FOUNDATION/BASEMENT: High Regular Low Material: StoneWALL COVER: Wood Robertson Shingle Brick Stone Other \_\_\_\_\_ROOF: Ridge Gambrel Flat Hip Mansard  
Tower Cupola Dormer windows Balustrade Grillwork \_\_\_\_\_CHIMNEYS: 1 2 3 4 Center End Interior Irregular Cluster ElaborateSTORIES: 1 2 3 4 ATTACHMENTS: Wings Ell Shed \_\_\_\_\_

PORCHES: 1 2 3 4 \_\_\_\_\_ PORTICO \_\_\_\_\_ Balcony

FACADE: Gable end: Front/Side Ornament: \_\_\_\_\_Entrance: Side Front Center/Side Details: Tan over front doorWindows: Spacing: Regular/Irregular Identical/Varied \_\_\_\_\_Corners: Plain Pilasters Quoins Cornerboards Corner over

5. Indicate location of structure in relation to nearest cross streets and other buildings

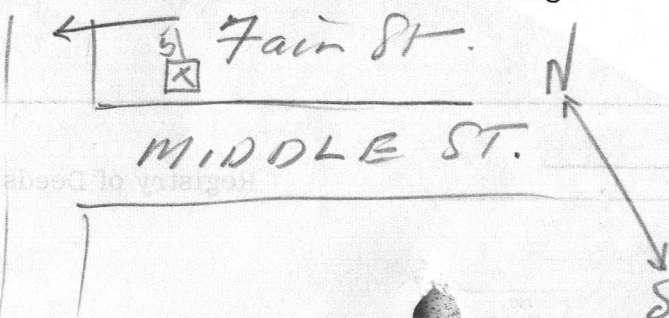
6. Footage of structure from street none  
Property has 100 feet frontage on streetRecorder Marion A. DwyerFor Historical Study CommPhoto Yes Date Feb 20/70

SEE REVERSE SIDE

# RELATION OF SURROUNDING TO STRUCTURE

NWB-65D

## 1. Outbuildings

2. Landscape Features: Agriculture Open Wooded Garden: Formal/Informal  
 Predominant features  
 Landscape architect

## 3. Neighboring Structures

Style: Colonial Federal Greek Revival Gothic Revival Italian Villa Lombard Rom.  
 Venetian Gothic Mansard Richardsonian Modern

Use: Residential Commercial Religious Conditions: Excellent Good Fair Deteriorated

GIVE A BRIEF DESCRIPTION OF HISTORIC IMPORTANCE OF SITE (Refer and elaborate on theme circled on front of form)

## BIBLIOGRAPHY AND/OR REFERENCE

## RESTRICTIONS

Original Owner:

Deed Information: Book Number Page Registry of Deeds