

Massachusetts Cultural Resource Information System

Scanned Record Cover Page

Inventory No:	NWB.635
Historic Name:	
Common Name:	
Address:	5 Federal St
City/Town:	Newburyport
Village/Neighborhood:	
Local No:	118; 19-107
Year Constructed:	C 1775
Architect(s):	
Architectural Style(s):	Federal
Use(s):	Single Family Dwelling House
Significance:	Architecture
Area(s):	NWB.D: South End District NWB.L: Newburyport Historic District
Designation(s):	Nat'l Register District (8/2/1984)



The Massachusetts Historical Commission (MHC) has converted this paper record to digital format as part of ongoing projects to scan records of the Inventory of Historic Assets of the Commonwealth and National Register of Historic Places nominations for Massachusetts. Efforts are ongoing and not all inventory or National Register records related to this resource may be available in digital format at this time.

The MACRIS database and scanned files are highly dynamic; new information is added daily and both database records and related scanned files may be updated as new information is incorporated into MHC files. Users should note that there may be a considerable lag time between the receipt of new or updated records by MHC and the appearance of related information in MACRIS. Users should also note that not all source materials for the MACRIS database are made available as scanned images. Users may consult the records, files and maps available in MHC's public research area at its offices at the State Archives Building, 220 Morrissey Boulevard, Boston, open M-F, 9-5.

Users of this digital material acknowledge that they have read and understood the MACRIS Information and Disclaimer (<http://mhc-macris.net/macrisdisclaimer.htm>)

Data available via the MACRIS web interface, and associated scanned files are for information purposes only. THE ACT OF CHECKING THIS DATABASE AND ASSOCIATED SCANNED FILES DOES NOT SUBSTITUTE FOR COMPLIANCE WITH APPLICABLE LOCAL, STATE OR FEDERAL LAWS AND REGULATIONS. IF YOU ARE REPRESENTING A DEVELOPER AND/OR A PROPOSED PROJECT THAT WILL REQUIRE A PERMIT, LICENSE OR FUNDING FROM ANY STATE OR FEDERAL AGENCY YOU MUST SUBMIT A PROJECT NOTIFICATION FORM TO MHC FOR MHC'S REVIEW AND COMMENT. You can obtain a copy of a PNF through the MHC web site (www.sec.state.ma.us/mhc) under the subject heading "MHC Forms."

Commonwealth of Massachusetts
Massachusetts Historical Commission
220 Morrissey Boulevard, Boston, Massachusetts 02125
www.sec.state.ma.us/mhc

This file was accessed on:

Friday, April 18, 2014 at 11:36 AM



NWB.635 *unc D+L* (635) (118)

	<i>MA</i>	<i>272</i>
--	-----------	------------

MISSION
Boston

2. Town Newburyport

Street address 5 Federal

Want to:
on

Name _____

with the
side):

Original use Res.

Present use "

Present owner Richard J. Clarkson

Open to public NO

Date _____ Style 18th - low

Source of date _____

Architect _____

- | | |
|---------------|--------------------------|
| Art/sculpture | Travel/communication |
| Education | Military affairs |
| Government | Religion/philosophy |
| Literature | Indians |
| Music | Development of town/city |

3. CONDITION: Excellent Good Fair Deteriorated Moved Altered Added

4. DESCRIPTION

FOUNDATION/BASEMENT: High Regular Low Material: Buck

WALL COVER: Wood Alum. clabards Brick Stone Other Alum. clabards ?

ROOF: Ridge Gambrel Flat Hip Mansard
Tower Cupola Dormer windows Balustrade Grillwork

CHIMNEYS: 1 2 3 4 Center End Interior Irregular Cluster Elaborate

STORIES: 1 2 3 4 ATTACHMENTS: Wings Ell Shed 1 story extension 12' wide

PORCHES: 1 2 3 4 — PORTICO across entire rear Balcony

FACADE: Gable end: Front/Side Ornament: _____

Entrance: Side Front Center/Side Details: _____

Windows: Spacing: Regular Irregular Identical/Varied _____

Corners: Plain Pilasters Quoins Cornerboards _____

5. Indicate location of structure in relation to nearest cross streets and other buildings

6. Footage of structure from street 5' from sidewalk
Property has 60' feet frontage on street

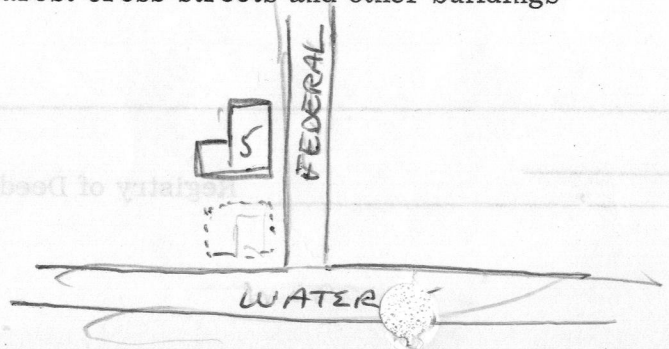

Recorder Se Barnes

For Newburyport Hist. Distr. Study Comm

Photo _____ Date 8/1/69

SEE REVERSE SIDE

RELATION OF SURROUNDING TO STRUCTURE

1. Outbuildings

Concrete block garage - 75' to rear of house

2. Landscape Features: Agriculture Open Wooded Garden: Formal/Informal

Predominant features

Landscape architect

3. Neighboring Structures

Style: Colonial Federal Greek Revival Gothic Revival Italian Villa Lombard Rom.
Venetian Gothic Mansard Richardsonian Modern

Use: Residential Commercial Religious

Conditions: Excellent Good Fair Deteriorated

GIVE A BRIEF DESCRIPTION OF HISTORIC IMPORTANCE OF SITE (Refer and elaborate on theme circled on front of form)

BIBLIOGRAPHY AND/OR REFERENCE

RESTRICTIONS

Original Owner:

Deed Information: Book Number Page , Registry of Deeds