

Massachusetts Cultural Resource Information System

Scanned Record Cover Page

Inventory No:	NWB.601
Historic Name:	
Common Name:	
Address:	253 High St
City/Town:	Newburyport
Village/Neighborhood:	
Local No:	241; 39-62
Year Constructed:	C 1750
Architect(s):	
Architectural Style(s):	Georgian
Use(s):	Single Family Dwelling House
Significance:	Architecture
Area(s):	NWB.A: High Street District NWB.L: Newburyport Historic District
Designation(s):	Nat'l Register District (8/2/1984)



The Massachusetts Historical Commission (MHC) has converted this paper record to digital format as part of ongoing projects to scan records of the Inventory of Historic Assets of the Commonwealth and National Register of Historic Places nominations for Massachusetts. Efforts are ongoing and not all inventory or National Register records related to this resource may be available in digital format at this time.

The MACRIS database and scanned files are highly dynamic; new information is added daily and both database records and related scanned files may be updated as new information is incorporated into MHC files. Users should note that there may be a considerable lag time between the receipt of new or updated records by MHC and the appearance of related information in MACRIS. Users should also note that not all source materials for the MACRIS database are made available as scanned images. Users may consult the records, files and maps available in MHC's public research area at its offices at the State Archives Building, 220 Morrissey Boulevard, Boston, open M-F, 9-5.

Users of this digital material acknowledge that they have read and understood the MACRIS Information and Disclaimer (<http://mhc-macris.net/macrisdisclaimer.htm>)

Data available via the MACRIS web interface, and associated scanned files are for information purposes only. THE ACT OF CHECKING THIS DATABASE AND ASSOCIATED SCANNED FILES DOES NOT SUBSTITUTE FOR COMPLIANCE WITH APPLICABLE LOCAL, STATE OR FEDERAL LAWS AND REGULATIONS. IF YOU ARE REPRESENTING A DEVELOPER AND/OR A PROPOSED PROJECT THAT WILL REQUIRE A PERMIT, LICENSE OR FUNDING FROM ANY STATE OR FEDERAL AGENCY YOU MUST SUBMIT A PROJECT NOTIFICATION FORM TO MHC FOR MHC'S REVIEW AND COMMENT. You can obtain a copy of a PNF through the MHC web site (www.sec.state.ma.us/mhc) under the subject heading "MHC Forms."

Commonwealth of Massachusetts
Massachusetts Historical Commission
220 Morrissey Boulevard, Boston, Massachusetts 02125
www.sec.state.ma.us/mhc

This file was accessed on:

Friday, April 18, 2014 at 12:44 PM



NWB.601 Area Q H 241 105
2. Town Newburyport 601
Street 253 High
Name USGS-Newburyport
Original Use _____
Present Use Home
Present Owner _____
Date 9/750 Style Georgian
Source of Date _____
Architect _____

3. CONDITION: Excellent Good Fair Deteriorated Moved Altered _____
IMPORTANCE of site to area: Great Little None SITE endangered by _____

4. DESCRIPTION

FOUNDATION/BASEMENT: High Regular Low Material: ?
WALL COVER: Wood Cleopatra's Brick Stone Other _____
STORIES: 1 2 3 4 CHIMNEYS: 1 2 3 4 Center End Cluster Elaborate Irregular
ATTACHMENTS: Wings Ell Shed Dependency Back Simple/Complex
PORCHES: 1 2 3 4 Portico Balcony _____ Recessed _____
ROOF: Ridge Gambrel Flat Hip Mansard
Tower Cupola Dormer windows Balustrade Grillwork _____
FACADE: Gable End: Front/Side Symmetrical/Asymmetrical Simple/Complex Ornament
Entrance: Front/Side Centered Double Features: _____
Windows: Spacing: Regular/Irregular Identical/Varied 2 1/2 altitud
Corners: Plain Pilasters Quoins Obscured _____

OUTBUILDINGS garage Back LANDSCAPING poor

5. Indicate location of structure on map below 6. Footage of structure from street 10'
Property has _____ feet frontage on street

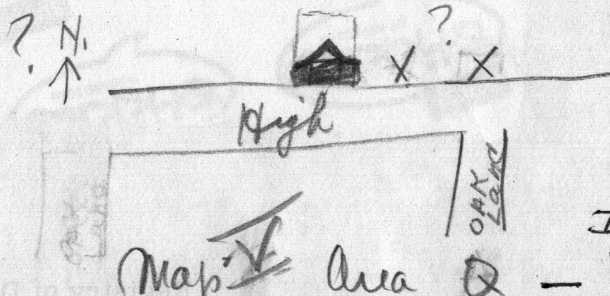

Recorder _____
For 68.3188
Photo 5A E 05 206-1-105

NOTE: Recorder should obtain written permission from Commission or sponsoring organization before using this form. (See Reverse Side)

FOR USE WITH IMPORTANT STRUCTURES (Indicate any interior features of note)

Fireplace

Stairway

Other

GIVE A BRIEF DESCRIPTION OF HISTORIC IMPORTANCE OF SITE (Refer and elaborate on theme circled on front of form)

REFERENCE (Where was this information obtained? What book, records, etc.)

